



# NTUCE 2022-2023 Study Abroad Info Session

臺大土木系 111學年度  
海外教育計畫說明會

Date: 23/November/2021 (Tuesday)  
Time: 12:20pm-1:30pm (Pastry box available from 12:00 - 12:20)  
Place: 220 Civil Engineering Building (Sorry, no food allowed)

Time 時間	Program 活動內容
12:00 - 12:20	入場, 自由入座。用餐, 請至203會議室。 Sign in. Please have food at CEB203.
12:20 - 12:25	主任致詞 Opening Remarks
12:25 - 12:45	副主任簡報 Briefing on NTUCE Study Abroad Programs
12:45 - 12:50	學生Adrianto Oktavianus介紹 印尼萬隆理工學院 Intro to ITB, Indonesia by Adrianto Oktavianus
12:50 - 12:55	學生黎英武介紹 越南河內土木大學 Intro to HUCE, Vietnam by Le Anh Vu
12:55 - 13:00	交換生陳佳宏分享至 德國BUW交換經驗 Exchange Experience Sharing by Steven Chen Chia-Hung
13:00 - 13:05	學生洪昊天介紹 香港城市大學和培璘人才培育計畫 Intro to CityU, Hong Kong & Y.L.Lin's Scholarship by Isaac Ho Tin-Hung
13:05 - 13:30	Q & A

# 提醒 / Reminder



DuDu (杜杜龍)

Dear DuDu(s),

Due to NTU's COVID-19 practices:

- 1) No eating is allowed during this event
- 2) Please wear a face mask at all time (except for presenter)
- 3) Please bring all your garbage with you

Thank you!

---

親愛的杜杜龍們,

請遵守學校防疫措施:

- 1) 活動過程中禁止飲食
- 2) 全程配戴口罩 (除了演講者)
- 3) 隨手將自己的垃圾帶走

謝謝!

# 說明會流程 / Agenda

- 12:00-12:20 ● ● 入場, 自由入座 & 用餐  
Sign in and have lunch
- 12:20-12:25 ● ● 主任致詞  
Opening Remarks
- 12:25-12:45 ● ● 副主任簡報  
Briefing on NTUCE Study Abroad Programs
- 12:45-12:50 ● ● 學生Adrianto Oktavianus介紹 印尼萬隆理工學院  
Intro to ITB, Indonesia by Adrianto Oktavianus
- 12:50-12:55 ● ● 學生黎英武介紹 越南河內土木大學  
Intro to HUCE, Vietnam by Le Anh Vu
- 12:55-13:00 ● ● 交換生陳佳宏分享至 德國BUW交換經驗  
Exchange Experience Sharing by Chen Chia-Hung
- 13:00-13:05 ● ● 學生洪昊天介紹 香港城市大學和和培璘人才培育計畫  
Intro to CityU, HK; Y.L.Lin's Scholarship by Ho Tin-Hung
- 13:05-13:30 ● ● Q & A

臺大土木系111學年度  
海外教育計畫說明會

NTUCE  
2022/2023

STUDY ABOARD INFORMATION SESSION

Opening Remarks

23 November 2021

主任

謝尚賢 教授

Chairman, Dept of Civil Engineering  
Professor Shang-Hsien HSIEH

臺大土木系111學年度  
海外教育計畫說明會

NTUCE  
2022/2023

STUDY ABOARD INFORMATION SESSION

NTUCE Study Abroad  
Programs

23 November 2021

副主任  
楊國鑫 教授

Associate Chair, Dept of Civil Engineering  
Professor Kuo-Hsin YANG

**Google Meet:**  
<https://meet.google.com/zoo-xxer-yge>

# 臺大海外教育計畫種類

## NTU Study Abroad Programs

- 1 ● — ● **交換學生計畫 Exchange Student Program**
- 2 ● — ● 訪問學生計畫 Visiting Student Program
- 3 ● — ● 寒暑假短期計畫 Short-Term Program
- 4 ● — ● 實習計畫 Internship Program
- 5 ● — ● **雙聯學位計畫 Joint/Dual/Double Degree Program**
- 6 ● — ● **獎學金 Scholarships**

# 臺大海外教育計畫層級

## Programs at Three Levels

1

University-  
Level  
校級

2

College-  
Level  
院級

3

Department  
-Level  
系級

1  
University-  
Level  
校級

26/Nov/2021 (Fri) & 27/Nov/2021 (Sat)  
Online from 9:30 am



<https://oia.ntu.edu.tw/study-abroad/exchangestudentfair/landing>



2

College-  
Level  
院級

30/Nov/2021 (Tue), 12:20-13:50  
Rm 203, 2<sup>nd</sup> Flr, College of Engr. Building



[http://www.eng.ntu.edu.tw/TC/news\\_in.aspx?cid=80&id=2210&chk=85f93831-42ac-4c3d-925f-8e953e8adaab&mid=9](http://www.eng.ntu.edu.tw/TC/news_in.aspx?cid=80&id=2210&chk=85f93831-42ac-4c3d-925f-8e953e8adaab&mid=9)

Please check from  
College of Engineering Chinese website  
NTUCOE (CHI) > 最新消息 > 訊息公告

**3**  
**Department-**  
**Level**  
**系級**

**PART I. Exchange Program**  
**交換生計畫**

**PART II. Joint/ Dual Degree**  
**雙聯學位**

**PART III. Scholarships**  
**出國獎學金**



# PART I. NTUCE Exchange Program

土木系交換學生計畫

IMPLEMENTED BY NTUCE

# PART I

## 交換學生

### Exchange

- — ● 建立在與姊妹校平等互惠的原則下，簽訂協議，互相提供出國及來校進行**短期、非學位**的學習機會。  
(Under the Reciprocity Principle, sign the agreement, **short term & non-degree** exchange program)
- — ● 前往姊妹校研修**一學期或一學年**，身分等同該校學生，所修學分可互相採認。 (1 semester or 1 year)
- — ● 若想參加，必須先參加出國**交換生甄選**，以取得提名資格，再檢送申請資料給姊妹校審核。  
(Internal screening process + get nominated and send required documents to the partner university)

# 14個系級 交換計畫

## 14 CE Student Exchange Programs

### 陸港澳 China

- 同濟大學 Tongji  
土木/交通學院
- 重慶大學  
Chongqing
- 浙江大學  
Zhejiang
- 香港理工大學  
POLYU

### 亞太 Asia-Pacific

- 印尼萬隆理工  
大學 ITB
- 泰國吞武里蒙庫國王  
科技大學 KMUTT  
土木/土木技術教育
- 越南國立土木  
工程大學  
HUCE
- 莫斯科建築學院  
MARKHI
- 越南百科大學  
HCMUT

### 歐 Europe

- 德國威瑪包浩斯  
大學 Bauhaus  
Universität  
Weimar (BUW)
- 比利時列日大學  
應用科學學院  
Université de  
Liège (ULg)
- 荷蘭鹿特丹應用科  
學大學 Rotterdam  
University of Applied  
Sciences(RUAS)

# 14系級 交換計畫

# 14 CE Student Exchange Programs

1	同濟大學 土木工程學院 Tongji (College of Civil Engineering)	學碩博 (B, M, D)	僅接受臺灣籍學生Taiwanese only
2	同濟大學 交通運輸工程學院 Tongji (College of Transportation Engineering)	學碩博 (B, M, D)	不接受在臺之中國學生 No Chinese students
3	浙江大學 Zhejiang	學碩博 (B, M, D)	僅接受臺灣籍學生Taiwanese only
4	重慶大學 Chongqing	學碩博 (B, M, D)	僅接受臺灣籍學生Taiwanese only
5	香港理工大學 HK PolyU	學 (B)	具英檢證明 English proof
6	萬隆理工大學 ITB	學碩博 (B, M, D)	具英檢證明 English proof
7	越南 河內國立土木工程大學 HUCE	學碩博 (B, M, D)	具英檢證明 English proof
8	越南 胡志明市百科大學 HCMUT	學碩博 (B, M, D)	具英檢證明 English proof
9	泰國 吞武里國王科技大學 土木工程學系 KMUTT (Dept of Civil Engineering)	學碩博 (B, M, D)	具英檢證明 English proof
10	泰國 吞武里國王科技大學 土木技術教育系 KMUTT (Dept of Civil Technology Engineering)	學碩博 (B, M, D)	具英檢證明 English proof
11	俄羅斯莫斯科建築學院 MARKHI	學碩博 (B, M, D)	具英檢證明 English proof
12	德國威瑪包浩斯大學 BUW	學碩博 (B, M, D)	具德檢定/上課或英檢證明 German or English proof
13	荷蘭鹿特丹應用科學大學 RUAS	學碩博 (B, M, D)	具荷檢或英檢證明 Dutch or English proof
14	比利時列日大學應用科學學院 ULg	學碩 (B, M)	具法檢或英檢證明 French or English proof

# Applicant Eligibility 申請資格

## 學籍 Student Status

● — ● 具本校學籍之學士生二年級(含)以上、研究生一年級(含)以上。  
Undergraduates must be year 2 or above. Graduate students must be year 1 or above.

## 成績 Grades

● — ● 學士生109學年度學年等第平均GPA達2.44(含)或學年全班排名前百分之五十。研究生無成績限制。  
Undergraduates GPA of 2.44 and above or in the top 50 % of the class. No grade or rank requirements for graduate students.

## 語言 Language

● — ● 申請非中國大陸地區交換學校者，需有英語或其他相關外語證明。Proof of English proficiency:  
Common European Framework of Reference for Languages (CEFR) B2 vantage level (TOEFL iBT 79, IELTS 6.0 or GEPT High-Intermediate)

# Application Timetable 申請時程

- |                             |       |  |
|-----------------------------|-------|--|
| 2021/Nov/15                 | ● — ● | 甄選簡章公告<br>Announce of Application Guidelines on Department Website |
| 2021/Dec/09-<br>2021/Dec/22 | ● — ● | 書面資料繳交<br>Application Submission                                   |
| To be announced             | ● — ● | 面試<br>Interview  |
| 2022/Jan/18                 | ● — ● | 錄取名單公告<br>Notification of Acceptance                               |
| 2022/Jan/26                 | ● — ● | 正取確認<br>Confirmation of Acceptance                                 |
| 2022/Jan/26-<br>Feb/17      | ● — ● | 備取結果個別通知<br>Notification of Acceptance for Waitlisted              |
| 2022/Feb/22                 | ● — ● | 遞補確認<br>Confirmation of Acceptance for Waitlisted                  |



# Application Materials 申請文件

- 1 ● ● 申請表  
Application form
- 2 ● ● 繳交報名費  
Application fee
- 3 ● ● 歷年成績單  
Academic transcript(s)
- 4 ● ● 華語或外語能力證明影本  
Proof of language proficiency
- 5 ● ● 讀書/研修計畫  
Statement of purpose/study plan (Preferably in English)
- 6 ● ● 研究成果摘要(僅研究生需繳交)  
Research abstract (Required for graduate students only)
- 7 ● ● 教授推薦表  
Professor recommendation letter
- 8 ● ● 其他有利文件  
Any additional documents

# Application Fee 繳交報名費 (NT\$300)

- 1) **Email** request then pickup from CEB209
- 2) Pay at Cashier Division
- 3) Payment Receipt

(Rm 115, 1<sup>st</sup> Flr of  
2<sup>nd</sup> Administrative Bldg)

國立臺灣大學 一般繳費單  
開立日期：109年02月10日

1091511A364

繳款人			
繳費總金額	300		
編號	主計室科目或代號	金額	事由(備註)
1	109P111	300	
合計：	300		
說明(注意事項)			
1 繳費期限：請於 2020/03/02 前至校地區出納櫃繳費。			
承辦單位	工學院 土木系		
承辦人 (請蓋職章或親簽)			
單位戳章			

(未蓋職章者請於此欄加蓋單位戳章)

【本繳費單僅可至國立臺灣大學校地區總務處出納櫃繳款】



國立臺灣大學 自行收納款項統一收據  
中華民國 109 年 02 月 10 日

統一編號：03734301  
109021179號

繳款人：[Redacted]

科目或代號	金額	事由
109P111工學院土木工程學系辦理本校生赴境外研修行政費收入	300	
以下空白		

合計新台幣叁佰元整

經手人：主計室 出納 主任 機關 長官 109 021179

第一聯：收據(繳款人收執)

國立臺灣大學 自行收納款項統一收據  
中華民國 109 年 02 月 10 日

統一編號：03734301  
109021179號

繳款人：[Redacted]

科目或代號	金額	事由
109P111工學院土木工程學系辦理本校生赴境外研修行政費收入	300	
以下空白		

合計新台幣叁佰元整

經手人：主計室 出納 主任 機關 長官 109 021179

第二聯：通知(業務單位留存)

# Scholarships

## 獎學金

- Scholarships may be available.  
視當年度經費情形，另行公告獎助學金相關辦法。
- Should an international student receiving **the Taiwan Scholarship** wants to study abroad as an exchange student, the scholarship **would be cancelled** according to the Taiwan Scholarship stipulations, and the remaining scholarship will not be retained or extended.

# Guidelines 簡章

2022-2023 土木工程學系 換學生計畫 甄選簡章

系務連結 社風電子報 English

臺大土木工程學系  
Department of Civil Engineering  
National Taiwan University

最新消息 系所簡介 系所成員 大學部 碩士班 博士班 在職專班 國際合作 研究中心

國際合作：姊妹校

- 姊妹校
- 訪賓交流
- 國際組織及國際會議
- 學生海外教育計畫

國際合作

- 姊妹校
- 訪賓交流
- 國際組織及國際會議

一、姊妹校一覽表

與本系締盟之姊妹校分布於亞歐美共12國/地區，合計25校如下一覽表

亞洲 Asia

2022-2023 NTUCE Outgoing Student Exchange Program Application Guidelines

APPLY NTU OIA CONTACT US 中文

臺大土木工程學系  
Department of Civil Engineering  
National Taiwan University

About Latest News Programs People International Scholarships Resources Collaboration

Partner Universities

- Dual/Joint Degree Programs
- Exchange Student Programs
- Internship Abroad Program

### (三) 本校學生出國交換

#### 1. 相關重要規章

- 國立臺灣大學辦理本校學生赴境外研修要點
- 國立臺灣大學學生出國修課學分採計要點

#### 2. 交換甄選簡章

- 2022-2023 土木工程學系交換學生計畫 甄選簡章.pdf
- 2022-2023 土木工程學系交換學生計畫 申請表.pdf
- 2022-2023 土木工程學系交換學生計畫 甄選簡章與申請表.odt

### 2. NTUCE Outgoing Student Exchange Program

Exchanging in 2022-2023 Academic Year (Semester: 2022 Fall, 2023 Spring)

Outgoing Student Exchange Program - Application Guidelines

Outgoing Student Exchange Program - Application Forms

Outgoing Student Exchange Program - Application Guidelines & Forms



# PART II. NTUCE Dual/Double/Joint Degree Programs

土木系雙聯學位

# 雙聯學位計畫簡介

## General Intro to Dual/Joint Degree Program

### 同一學制內(學/碩/博)

#### Same-Study-Level Degree Program

滿足兩校要求之畢業條件後，同時取得兩校學士、碩士或博士學位。

- Spend ½ of the study period abroad for a certain degree
- Fulfill both universities' graduation requirements
- Get 2 same-study-level diplomas: NTU and partner university's

### 跨學制的學、碩雙聯學位(3+2雙聯)

#### 3+2 Bachelor's Master's Degree Program

大學部學生在本校完成前三年學業，第四年至對方學校修習，最終滿足臺大畢業條件後取得臺大學士班學位，第五年繼續在對方學校修習研究所課程，滿足對方畢業條件後獲對方之碩士學位。

Bachelor Students study at NTU for 3 years and do the 4<sup>th</sup> year abroad, fulfill NTU's graduation requirements, and get NTU's bachelor diploma; continue on with the 2<sup>nd</sup> year study abroad, fulfill partner university's graduation requirements, and get a Master diploma from that university.

學士雙聯學位

# Joint Bachelor's Degree Programme



香港城市大學  
City University of Hong Kong

專業 創新 胸懷全球  
Professional · Creative  
For The World

香港城市大學 建築與土木工程系

## City University of Hong Kong, HK

## 3+1+X 學碩雙聯學位

### 3+1+X Bachelor/Master's Degree Program



UNSW  
SYDNEY

澳洲新南威爾斯大學

**The University of New South Wales, AUS**

## 3+2 學碩雙聯學位

### 3+2 Joint Bachelor/Master's Degree Program



美國加州大學聖地牙哥分校 結構工程學系

**University of California, San Diego, USA**



# 碩士雙聯學位

## Dual/Joint Master Degree Programs



英國里茲大學 交通運輸研究所  
**University of Leeds, UK**



越南胡志明市百科大學 土木工程系  
**Ho Chi Minh City University of Technology  
(HCMUT), Vietnam**

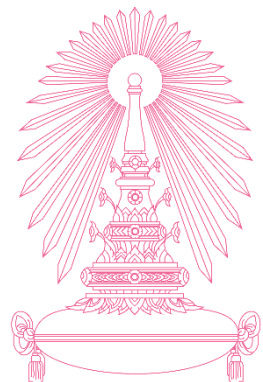

泰國朱拉隆功大學 工學院  
**Chulalongkorn University, Thailand**

# 博士雙聯學位 Dual Ph.D. Degree Programs



Curtin University

澳大利亞科廷大學 人文學院居住環境學系

**Curtin University of Technology, Australia**



香港城市大學  
City University of Hong Kong

專業 創新 胸懷全球  
Professional · Creative  
For The World

香港城市大學 建築與土木工程系

**City University of Hong Kong, HK**

# 香港城市大學 建築與土木工程系

## Dept. of Architecture and Civil Engineering, City University of Hong Kong (CityU)

### 雙聯學士學位 Joint Bachelor's Degree Programme

#### 計畫期程 Program Duration & Years of Study:

- Study the same approved major at CityU and NTU throughout the 4 years
- 1st and last years at NTU; 2nd and 3rd years at CityU. → 1+2+1

#### 申請資格 Eligibility :

- 在本校完成至少1學期 Completed at least 1 semester, full-time undergraduate study
- CGPA 3.3 or above
- 英檢成績：TOEFL iBT 79 或紙本550；IELTS總成績6.5；學測或指考英文成績達頂標。  
English proficiency: TOEFL iBT 79 (paper-based 550), or IELTS 6.5, or other equivalent scores.
- 不接受香港同學申請。 Not eligible for students from Hong Kong.

# CityU's 雙聯學士學位 Joint Bachelor's Degree Programme

## 教學語言 Medium of Instruction:

- English in both institutions, except for some courses, such as Chinese Civilisation - Chinese and Philosophy at CityU and Chinese I (國文領域上) and Chinese II (國文領域下) at NTU, which are offered in Chinese
- Get prior approval from academic advisors if students have no choice but to take any non-English teaching course

## 學費 Tuition:

修習雙聯學位期間，繳臺大學雜費；赴港期間，加繳雙聯學位行政費。

Pay NTU's tuition fees at all time.

Pay extra administrative fees while studying in HK.

## 名額 Quota: 5

校內申請截止日期 Application Deadline (暫定 Tentative): **February 24, 2021**

# 臺大及城市大學學士學位授予之學分規定

## NTU and CityU's approved majors

	CityU	NTU
學位授予 Degree Conferral	工學士 (土木工程) Bachelor of Engineering in Civil Engineering	工學學士 Bachelor of Science in Engineering
學分要求 Minimum Graduation Credit Requirements	<ul style="list-style-type: none"> <li>• Gateway Education: 30</li> <li>• College Requirement: 6</li> <li>• Major: 84 (Core:72; Electives: 12)</li> </ul> <p><b>Total Minimum Required Credits: 120</b></p>	<ul style="list-style-type: none"> <li>• University Compulsory Courses: 12</li> <li>• University General Courses: 12</li> <li>• Dept. General Compulsory Courses: 12</li> <li>• Dept. Professional Compulsory Courses: 49</li> <li>• Field Specialized Compulsory Course: 14</li> <li>• F-Level (Topical Compulsory) Courses: 12</li> <li>• Field Specialized Elective Courses: 12</li> <li>• Univ. Elective Courses: 8</li> </ul> <p><b>Total Minimum Required Credits: 131</b></p>

# 澳洲新南威爾斯大學

## The University of New South Wales

### 3+1+X 學碩雙聯學位

3+1+X Bachelor's +  
Master's Program

#### 申請資格 Eligibility:

- 學士班3年級之在學生  
Current 3<sup>rd</sup> year or above undergraduate student
- NTU GPA 3.3 out of 4.3 or above (UNSW WAM 65)
- 英檢成績 English Language Proficiency: TOEFL iBT > 90 or IELTS > 6.5

**學費 Tuition:** 臺大畢業前、在澳大利亞期間，繳兩校全額學雜費。

During the stay at UNSW & before graduating from NTU, NTU students are required to pay full tuition and miscellaneous fees to both NTU and UNSW (int'l student tuition).

校內申請截止日期 Application: **Anytime**

# 美國加州大學聖地牙哥分校 結構工程系

## UC San Diego Department of Structural Engineering

**3+2 學碩雙聯學位**  
3+2 Program in  
Engineered Structures

### 申請資格 Eligibility:

- 學士班3年級之在學生  
Current 3<sup>rd</sup> year or above undergraduate student
- GPA 3.5/4.0 or above (NTU's GPA is under 4.3. Please convert by yourself.)
- 英檢成績 English Language Proficiency: TOEFL iBT > 85 or IELTS > 7 (preferably > 7.5)

**學費 Tuition:** 臺大畢業前、在美期間，繳兩校全額學雜費。  
在美第二年，可申請獎學金。

During the stay at UCSD & before graduating from NTU, NTU students are required to pay full tuition and miscellaneous fees to both NTU and UCSD (Non-Resident Tuition). Students are eligible for funding in the 2<sup>nd</sup> year at UCSD.

校內申請截止日期 Application Deadline (暫定 Tentative): **March 2, 2021**

# 英國里茲大學交通運輸研究所

## Institute for Transport Studies (ITS), University of Leeds, UK

**1+1 雙碩士學位**  
Dual Masters Degrees

### 申請資格 Eligibility:

- 在臺大修讀一年，去里茲修讀12個月(完整碩士課程)。  
1 year of full-time study at NTU + 12 months full-time Master's study at ITS
- 符合里茲入學條件：GPA 75% 以上；IELTS總成績6.5以上，每單元成績不得低於6.0。  
GPA 75% or above; IELTS 6.5 overall, with no component less than 6.0, or equivalents

**學費 Tuition:** 在臺期間，繳臺大學雜費；在英期間，繳臺大+里茲學雜費(由本系推薦得減10%學費)

Pay NTU's tuition while studying in Taiwan.

Pay NTU and ITS' tuition while studying in UK, with a 10% off Leed's tuition if nominated by NTU.

**備註 Remark:** 此為二年制學程，除畢業學分之外，須完成兩本論文。

The full-time study period is at least 2 years. Students are required to fulfil all requirements including completion of 2 separate dissertations.

相關資訊：<https://environment.leeds.ac.uk/transport>



# 泰國朱拉隆功大學 工學院

## College of Engineering, Chulalongkorn University, Thailand

雙碩士學位

Dual Masters  
Degrees

### 申請資格 Eligibility:

- 在本校完成至少1學期  
Completed at least 1 semester, full-time Master's study
- 入學英文條件 English Proficiency: TOEFL iBT 67, TOEFL PBT 500, or IELTS 5.5 and higher

### 計畫期程 Program Duration & Years of Study:

- 第一及第四學期在臺大就讀，第二、三學期於泰國修讀  
1st and last semesters at NTU; 2nd and 3rd semesters at Chulalongkorn → 0.5+1+0.5
- 至少需在泰國待一學年，最多不得超過修讀碩士學位期間的一半時程。  
Students must spend at least 1 academic year of study at Chulalongkorn and not exceed ½ of the total study period.

**學費 Tuition:** 在臺期間，繳臺大學雜費；在泰期間，繳臺大雜費

Pay NTU's tuition and miscellaneous fees both when studying at NTU and at CU.

**校內申請截止日期 Application Deadline:** TBA

# 澳大利亞科廷大學人文學院居住環境學系

## School of Built Environment, Faculty of Humanities, Curtin University, Australia

雙博士學位  
Dual Ph.D.  
Degree Program

### 申請資格 Eligibility:

- 符合兩校入學條件  
Meet all entrance requirements of both home and host institution.
- 依兩校指導教授另訂個人雙學位協議  
According to participating supervisors' mutual consent, sign a personal agreement.

**學費 Tuition:** 於母校繳交學雜費；在科廷，該校提供免學雜費或學費獎學金  
Program application and registration (tuition) fees will be paid to NTU.  
Tuition fee scholarships shall be provided by Curtin University.

**備註 Remark:** 學習期間應均分在兩校，每校不得少於12個月

Time spent in the Program should be equally divided between the 2 institutions in joint supervision and no less than 12 months at each institution.

# 香港城市大學

## City University of Hong Kong (CityU)

### 雙博士學位

Joint Ph.D.  
Programme

#### 申請資格 Eligibility :

- 在本校完成博士班至少1學期  
Finish at least 1 semester of Ph.D. study at NTU.
- 符合兩校入學條件  
Meet both institutions' admission requirements.
- 在兩校指導教授協商後，另訂個人雙學位協議  
After participating supervisors' mutual consent, sign a personal agreement.

**學費 Tuition:** 在臺期間，繳臺大學雜費；在港期間，繳城大學雜費，或有獎學金  
Pay NTU's tuition while studying in Taiwan; pay CityU's tuition while studying in HK.  
Scholarships may be granted to participants.

**執行單位 Office in Charge:** 土木系 Department of Civil Engineering

# **Additional Dual/Joint/Double Degree Program Information**

**(would be announced and implemented by  
the Office of International Affairs)**

**Univ.**

# 美國天普大學 Temple University, USA

**學+碩雙聯學位**  
Dual Bachelor's  
Master's Degree

## 申請資格 Eligibility:

- 學士班3或4年級，於本校僅剩3門以下未修習課程之在學生  
3<sup>rd</sup> or 4<sup>th</sup> year undergraduate student who has only 3 courses left to take before graduate
- GPA 3.3/4.3 (3.0/4.0) or above
- 英檢成績 English Language Proficiency: 須達TOEFL iBT 79以上或IELTS Academic 6.5以上

**學費 Tuition:** 臺大畢業前、在美期間，繳兩校全額學雜費。GPA 3.0以上，可獲天大學費減免。  
During the stay at Temple, NTU students are required to pay both full tuition and miscellaneous fee of NTU and those of Temple's. GPA 3.0 and higher will automatically receive tuition discount.

**申請截止日期 Application Deadline:** TBA

**執行單位 Office in Charge:** 國際處 OIA

**相關規定 Info:** [http://oia.ntu.edu.tw/ntu\\_student/ntu-dual/Temple](http://oia.ntu.edu.tw/ntu_student/ntu-dual/Temple)

# 土木系主辦之雙聯學位計畫行政費用架構 (單位：新臺幣/元)

## Administration Fee Structure for CE Dual/Joint Degree Programs (Unit: NT\$)

合作學校 Collaboration Institutions	申請費 Application Fee	以學期計 Per Semester	
		行政管理費 Program Mgmt Fee	課程計畫費 Course Planning Fee
1. 澳洲新南威爾斯大學(學碩雙聯) Univ. of New South Wales (Bachelor's+Master's)	300	1,000	0
2. 美國加州大學聖地牙哥分校(學碩雙聯) UC San Diego (Bachelor's+Master's)			
3. 英國里茲大學(雙碩士) University of Leeds (Dual Master's)			
4. 越南胡志明市百科大學(雙碩士) Ho Chi Minh City University (Dual Master's)			
5. 澳洲科廷大學(雙博士) Curtin University, Australia (Joint Ph.D.)			
6. 香港城市大學(雙學士、雙博士) City Univ. of HK (Joint Bachelor & Joint Ph.D.)			



## PART III. Scholarships

出國獎學金

# PART III

## 出國獎學金

### Scholarships

**Note:** For latest scholarship info, please visit [NTUOIA website](#) > Study Abroad > Exchange Student Program > Scholarships for Exchange Student  
(NTUOIA last update: 13/October/2021)

### 📌 臺大「出國交換學生」 & 「希望出航」

- NTU Outgoing Exchange Student Scholarship
- NTU Voyage of Aspirations Scholarship

### 📌 教育部「學海惜珠」

- MOE Outgoing Exchange Student Financial Assistance Grant

### 📌 堉璘獎學金

Y. L. Lin's Scholarship - National Taiwan University

### 📌 財團法人台大土木文教基金會獎學金

NTU Civil Engineering Culture and Education Foundation Scholarships



1

## 臺大「出國交換學生」計畫 NTU Outgoing Exchange Student Scholarship

### 申請資格 Eligibility:

- — ● **1. 甄選成績優異者**  
Excellent internal screening score
- — ● **2. 赴當年度重點推動姊妹校者**  
Joining listed partner universities exchange program as announced by the OIA yearly
- — ● **3. 系會另行通知錄取的交換生申請方式及截止日期。**  
Dept will email nominated exchange students when application period begins.

2

## 臺大「希望出航」計畫 NTU Voyage of Aspirations Scholarship

### 申請資格 Eligibility:

- 1. 經濟不利或文化不利學生  
Proof of economic disadvantage or cultural disadvantage.
- 2. 非中華民國籍學生，持有國籍所在地當年度政府機關出具清寒/低收入戶/免繳稅證明。 For non-Taiwanese students, please provide your current year's proof of low-income/tax exemption issued by your government agencies.
- 3. 系會另行通知錄取的交換生申請方式及截止日期  
Dept will email nominated exchange students when application period begins

3

## 教育部鼓勵國內大專校院選送學生出國研修「學海惜珠」計畫 MOE Outgoing Exchange Student Financial Assistance Grant

### 申請資格 Eligibility:

- ● 1. 須具中華民國國籍，且在臺灣地區設有戶籍者。持有當年度政府機關開立之低、中低收入戶證明。 Taiwanese students with proof of low or middle-low income households only.
- ● 2. 非錄取中國大陸、香港或澳門地區學校者。  
Not going to universities in mainland China, Hong Kong or Macau.
- ● 3. 系會另行通知錄取的交換生申請方式及截止日期。  
Dept will email nominated exchange students when application period begins.

4

## 堉璘-臺大人才培育計畫

### Y. L. Lin's Scholarship - National Taiwan University

#### 申請資格 Eligibility:

- ● 1. 海外交換、訪問、實習、寒暑期課程、頂尖實驗室  
Overseas exchange, visit, internship, winter/summer courses, top-notch laboratories.
- ● 2. 海外雙聯學位、碩士班、博士班及經認可之進修方式  
Overseas dual degree, or graduate students.
- ● 3. 臺灣大學的在校學生 (不含休學生)  
NTU current students (not including students in suspension)
- ● 4. 申請學位研修組別得為本校畢業5年內畢業生，視畢業證書之日期為準  
Applicants for the degree program must have graduated within these 5 years
- ● 5. 台大外籍生/僑生可申請 (不得申請原國籍國家學校)  
NTU Int'l & Oversea students may apply (not to country of origin).

- For **more information**, please visit <https://yllproject.ntu.edu.tw> (In Chinese only)

- Application: 2021/Oct/23 to 2021/Oct/31

3. 141592653589  
793238462643  
38327950  
288419  
716939  
937510

臺灣的區域定位

建構知識社會

GIVE YOURSELF A GLOBAL EDGE

# 培璘臺大- 人才培育計畫

從關心社會議題開始，尋找解決方案  
和我們一起，跨出第一步行動去實踐

海外學位研修 最高補助 <b>200萬</b>	海外非學位研修 最高補助 <b>70萬</b>	提供名額 最高每年 <b>90名</b>
-------------------------------	-------------------------------	----------------------------

超高齡社會

媒體識讀挑戰

面對移民移工



第五屆

**申請資訊**  
申請時間 | 10/23(六)至 10/31(日)  
申請資格 | 國立臺灣大學在學生等  
申請表單 | 10月中旬公告於官網  
官方網站 | yllproject.ntu.edu.tw

**線上招募說明**  
第一場 9/28(二) 17:40-18:20  
第二場 9/30(四) 12:40-13:20



報名說明會  官方網站

5

財團法人台大土木文教基金會獎學金-獎助出國參與學術會議  
NTU Civil Engineering Culture and Education Foundation  
Scholarships

- Subject to yearly budget.
- Dept will email nominated exchange students when application period begins.

# Agenda 說明會流程

- 12:45-12:50 ● 學生Adrianto Oktavianus介紹 印尼萬隆理工學院  
Intro to ITB, Indonesia by Adrianto Oktavianus
- 12:50-12:55 ● 學生黎英武介紹 越南河內土木大學  
Intro to HUCE, Vietnam by Le Anh Vu
- 12:55-13:00 ● 交換生陳佳宏分享至 德國BUW交換經驗  
Exchange Experience Sharing by Chen Chia-Hung
- 13:00-13:05 ● 學生洪昊天介紹 香港城市大學和和堉璘人才培育計畫  
Intro to CityU, HK & Y.L.Lin Scholarship by Ho Tin-Hung
- 13:05-13:30 ● Q & A



# INSTITUT TEKNOLOGI BANDUNG

*In Harmonia Progressio*

萬隆理工學院



# Adrianto Oktavianus

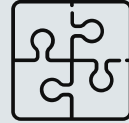

## Educational Background

- Bachelor in Civil Engineering, ITB, Indonesia
- Master in Urban Management, TU Berlin, Germany



## Working Experiences

- Construction Engineering and Management Research Group, FCEE, ITB
- Consultant for Research and Industrial Affiliation



## Current Profession

- PhD Student in Civil Engineering, NTU, Taiwan



TABLE OF CONTENTS

01

Bandung and Institut  
Teknologi Bandung

02

Faculty of Civil and  
Environmental Engineering,  
ITB

03

- #1 Reason on why you should go to ITB
- #2 Reason on why you should go to ITB
- #3 Reason on why you should go to ITB

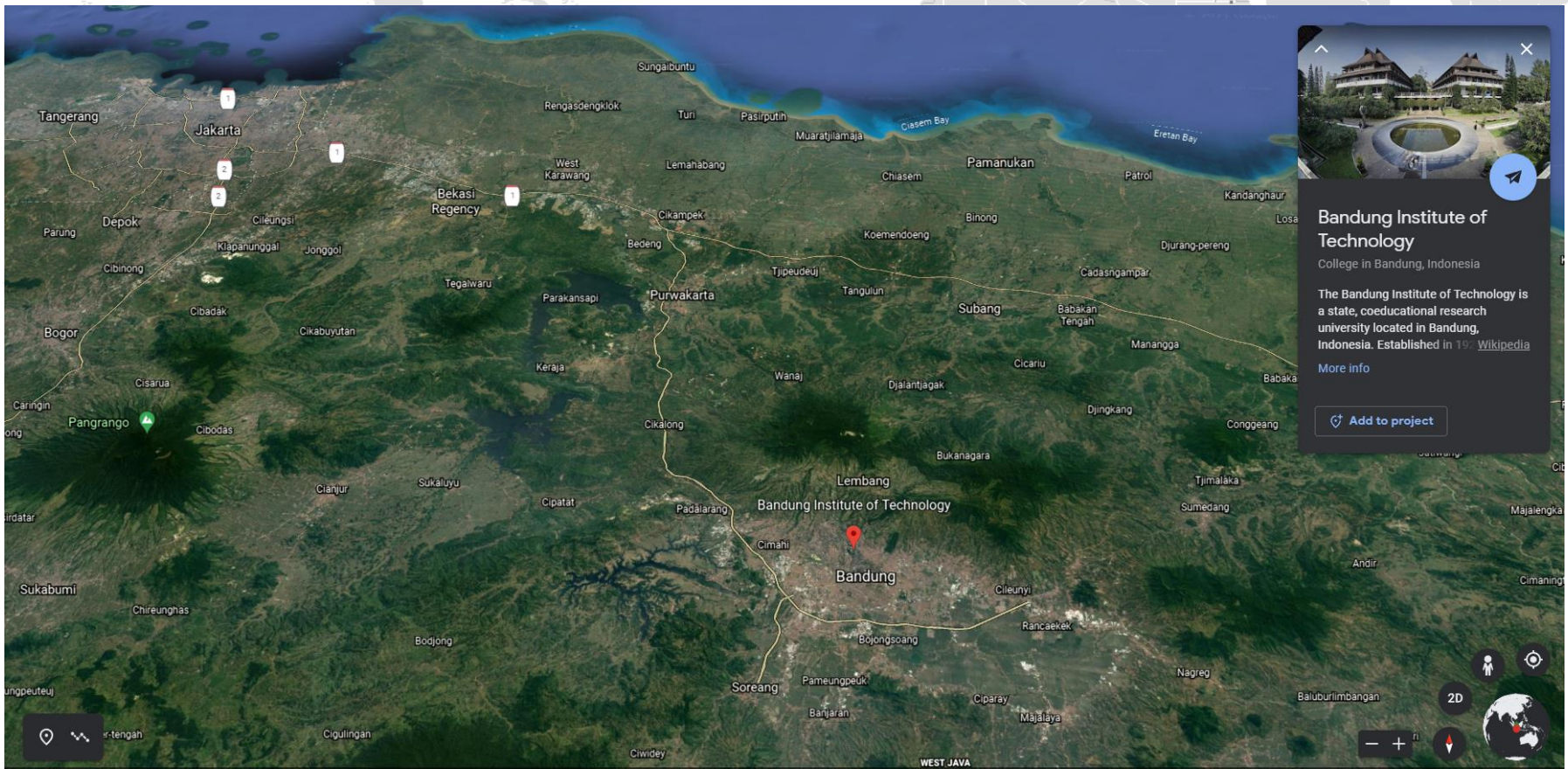

**Institut Teknologi Bandung** is located in Bandung, West Java, Indonesia.

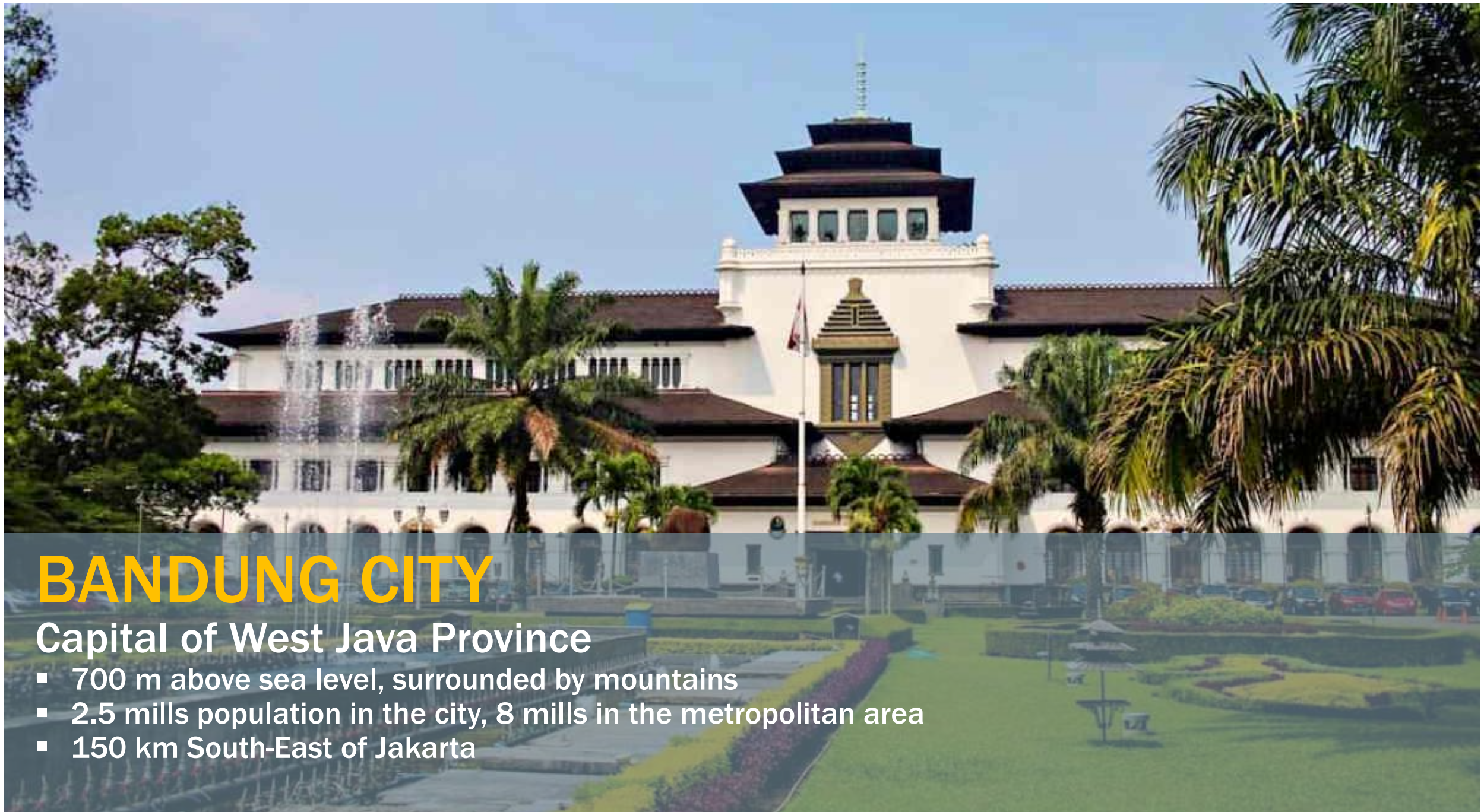

# BANDUNG CITY

## Capital of West Java Province

- 700 m above sea level, surrounded by mountains
- 2.5 mills population in the city, 8 mills in the metropolitan area
- 150 km South-East of Jakarta



**Institut Teknologi Bandung** was established on March 2, 1959 in Bandung, West Java. **ITB** is the first and the best university for engineering in Indonesia.



#### Worldrank

THE World Rankings 2021	1001+
THE Asia Rankings 2021	301-350
QS World Rankings 2022	#303
QS Asian Rankings 2021	#62
Engineering and Technology	#256
Natural Sciences	#451 - #500
Social and Management	#331



#### Teaching and Learning

Multicampus	2
Faculties and Schools	12
Programs	130
Joint Degrees	10
Lecturers	1.447
Students	23.848

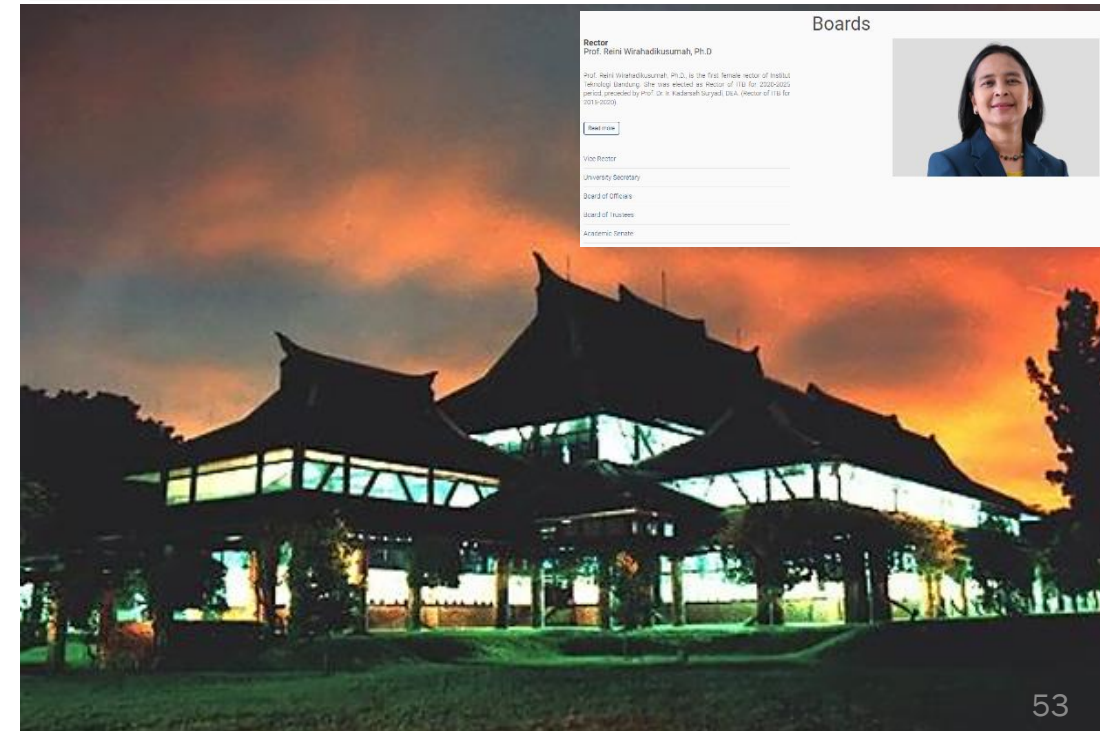

## Video: ITB Profile

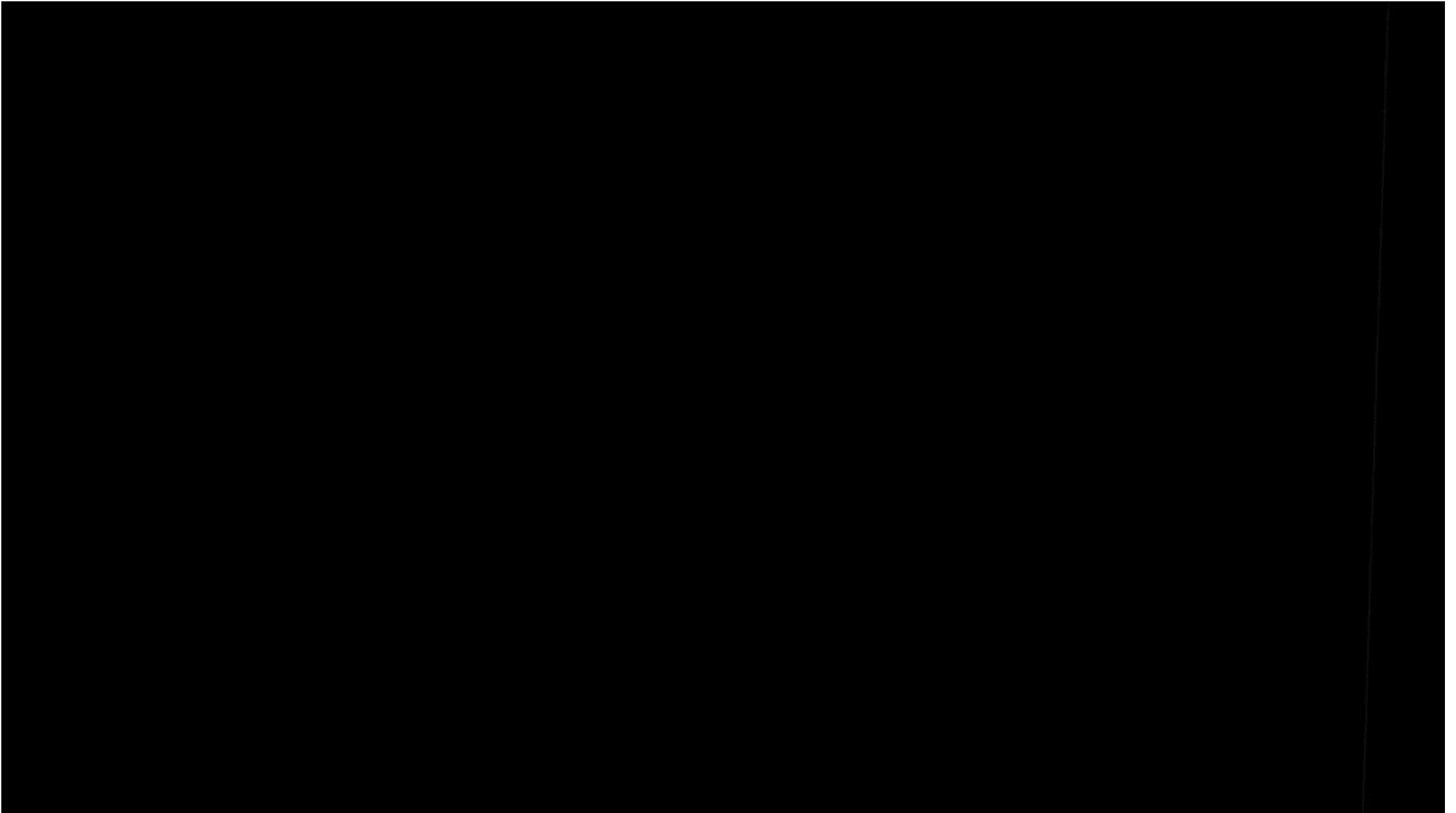



**“In Harmonia Progressio”**  
**a progress in harmony**

**ITB** strives to continue creating an excellence progress by combining aspects of **Science, Technology, Art, and Social Humanities.**



# Faculty of Civil and Environmental Engineering

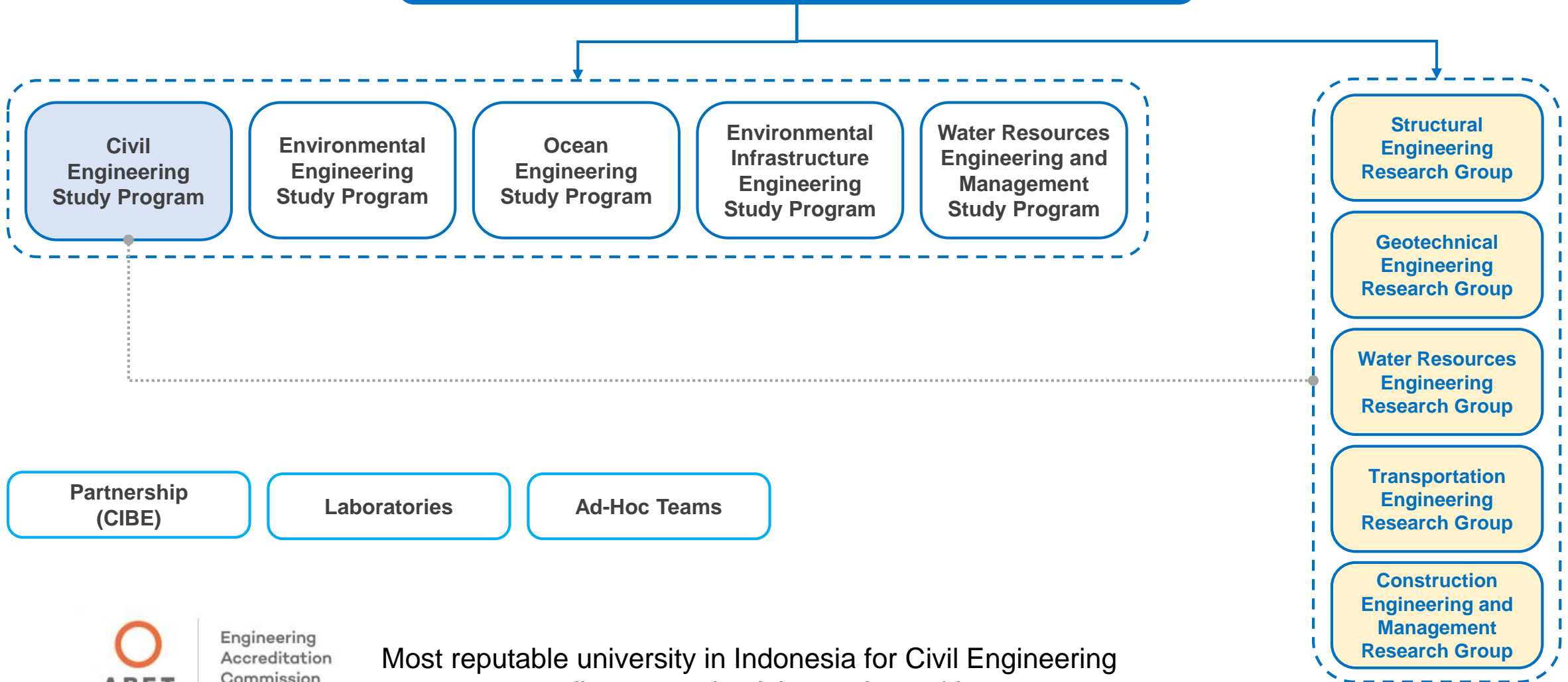

Engineering  
Accreditation  
Commission

Most reputable university in Indonesia for Civil Engineering program according to academician and practitioners





# #1 Learn from the best

- ITB's Civil Engineering Professors are at the forefront of the industry. Every large project in the country will involve them.
- Learn from their experience, which may not be able to be learned elsewhere.

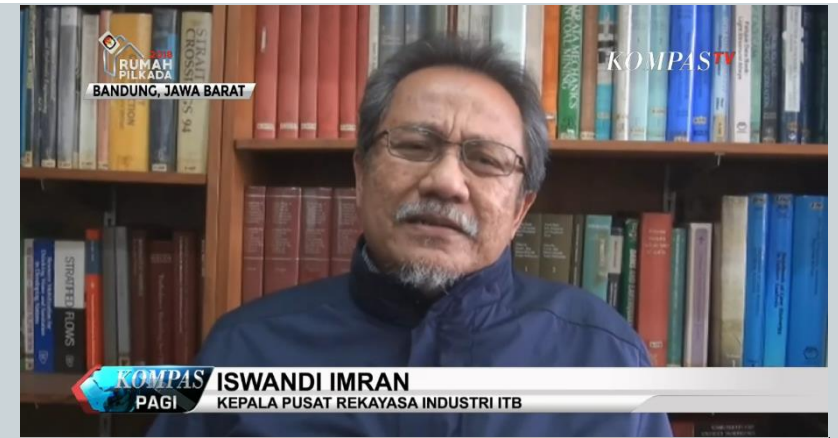

# #2 Courses in English

Code	Course	Units	Study Program
SI3111	Structural Analysis I	3	Civil Engineering
SI3211	Structural Analysis II	3	
SI4112	Advanced Concrete Structures	3	
SI4233	Hydropower Engineering Building	3	
SI2211	Soil Mechanics I	3	
SI3121	Soil Mechanics II	3	
SI3221	Foundation Engineering	3	
TL2105	Environmental Health	3	
TL2201	Fluid Mechanics II	3	
TL2202	Solid Waste Management	3	
TL2203	Environmental Microbiology	3	
TL2204	Hidrology and Hidrogeology	3	
TL2205	Environment Epidemiology	2	
TL2206	Water Quality Management	2	
TL3103	Environmental Laboratory	3	
TL3201	Air Pollution	3	
TL3202	Sustainable Sewerage and Drainage	3	
TL3203	Water Management	2	
TL3204	Environmental Engineering Management	3	
TL3205	Environmental Policy and Law	2	
TL3206	Solid Waste Treatment	2	
KL3200	Basic Random Waves	3	Ocean Engineering
KL3205	Construction Management of Ocean Structures	3	
KL3208	Boundary Element Method	2	
KL4200	Introduction to Ocean Energy	2	
KL4220	Subsea Pipeline	2	
SA3213	River, Lowland, and Lake Ecosystem	2	Water Resources Engineering and Management
IL4110	Waste to Energy	2	Environmental Infrastructure Engineering



# #3 Excellent Atmosphere for Students

## Student competition

57<sup>th</sup> Concorso International  
in Canto Corale-Seghizzi



Design Tender Competition,  
ITB Civil Engineering Expo



Bridge Design Competition,  
Nanyang Technological University of Singapore



Dam construction design competition 2018  
in Makassar

# #3 Excellent Atmosphere for Students

## Student excursion

Cinere-Jagorawi (Cijago) Highway, West Java



Kertajati Majalengka International Airport, West Java



Ancol Reclamation, Jakarta



# #3 Excellent Atmosphere for Students

## Student community service



**Sibades/Civil Engineering Build Villages;** an implementation of community service by Civil Engineering Student Association (HMS ITB)

- ❑ Earthquake resistant school building in Pangalengan , West Java.
- ❑ River weir/ low dam in Margamukti, West Java.
- ❑ Cicariu bridge in Cipeundeuy, West Java.
- ❑ Water reservoirs in Tasikmalaya and Cimaung, West Java.



# #4 Bandung: A Perfect Place!

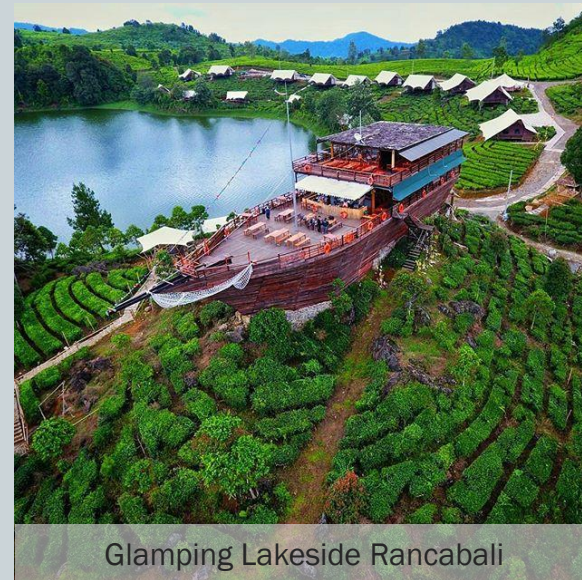

# KELIMUTU

FLORES ISLAND, INDONESIA



## #5 Explore the culture and your soul!

Bali, Kelimutu, Komodo island, Lombok, Bromo, Yogyakarta, and so many others..







# Thank you for listening!



<https://english.ftsl.itb.ac.id/>



@adrisialder



**TRƯỜNG ĐẠI HỌC XÂY DỰNG HÀ NỘI**  
**HANOI UNIVERSITY OF CIVIL ENGINEERING (HUCE)**



**INTERNATIONAL EXCHANGE PROGRAMME  
FOR INTERNATIONAL STUDENT**



**1. We are HUCE**

**2. Exchange programs**

**3. Workshops and  
Activities**



# 1. We are HUCE

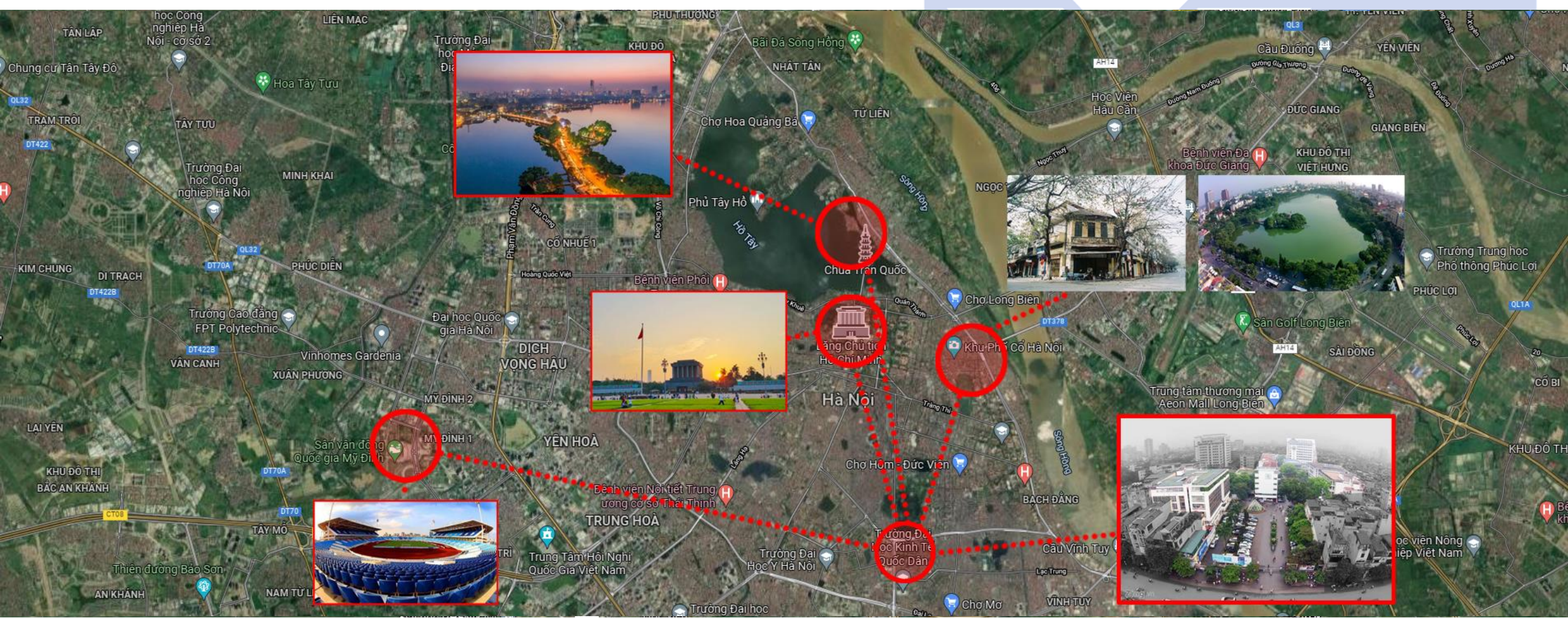

## Staff

• 986 staff, 785 academics and 201 support staff.

- The academics comprises
  - 21 professors, 82 associate
  - 288 doctors and 355 masters.
- 72% of academic staff possess post

graduate degrees. (one of the highest record in Vietnam universities)

- 30,000 Undergraduate students
- 1,768 Postgraduate students

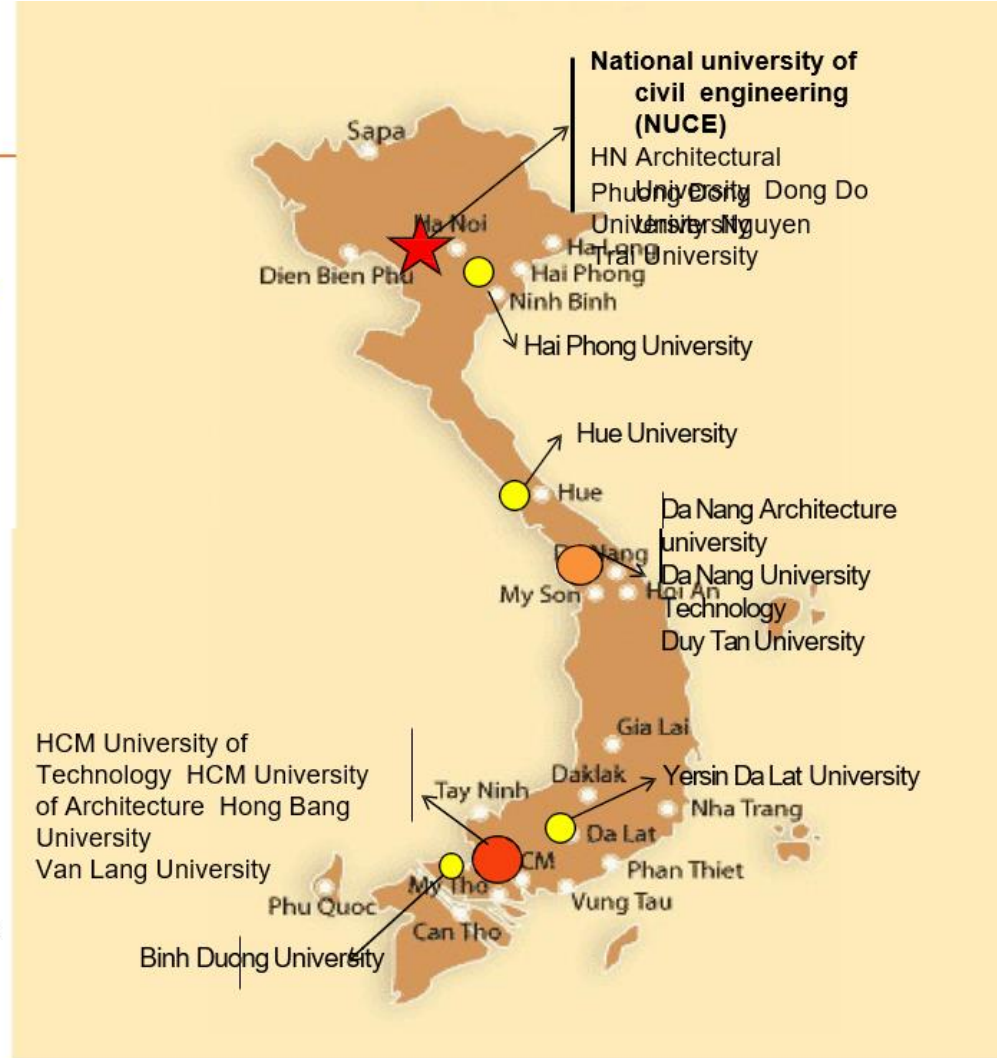

## THE NATIONAL UNIVERSITY OF CIVIL ENGINEERING (NUCE)

There are 17 higher institutions of architecture and construction in Vietnam. The National University of Civil Engineering is the largest.

The University was established in 1966 from the former biggest Faculty of Civil Engineering of the Hanoi University of Technology

In a distance of around one hour by car from the International airport

# 1. We are HUCE

- **Lecture buildings:** > 170 rooms and 12 halls  
**H1** (6 stories) - **H2** (4 stories) - **H3** (7 stories):
- **Office building:**  
**A1** (6 stories, 5750 m<sup>2</sup>): offices for University Management Board, Faculties, Departments, and other Boards and Divisions  
**A2** (2 stories) office for research institutes and center of NUCE
- Library (5 stories, 5490 m<sup>2</sup>)
- G3 meeting hall (900 seats, 1200 m<sup>2</sup>)
- Laboratory building ( 11 stories - 11500 m<sup>2</sup>)
- Environmental Centre and Laboratories (3 stories, 824 m<sup>2</sup>)

## Giai Phong Campus



# 1. We are HUCE



## Ha Nam Campus

# 1. We are HUCE

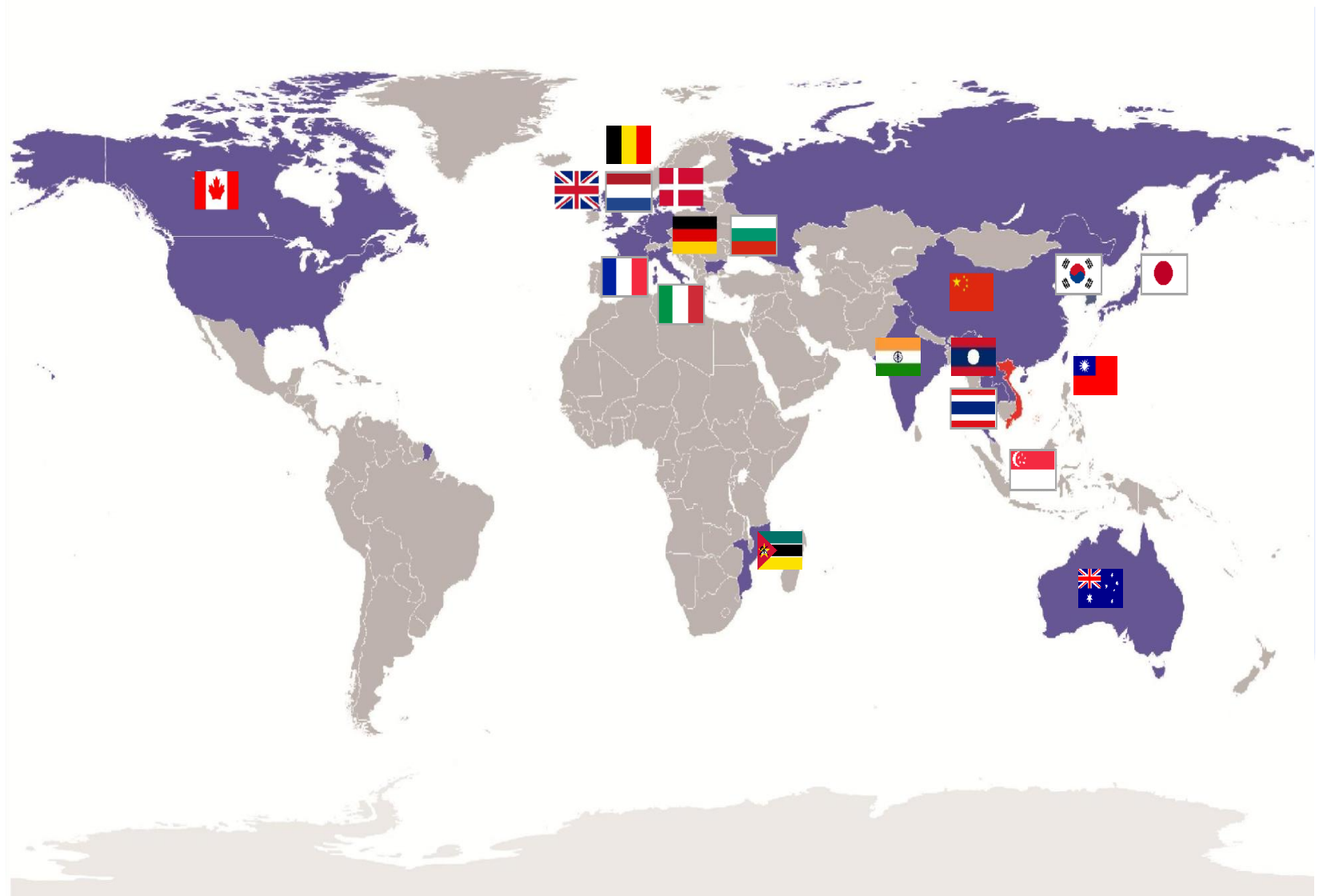
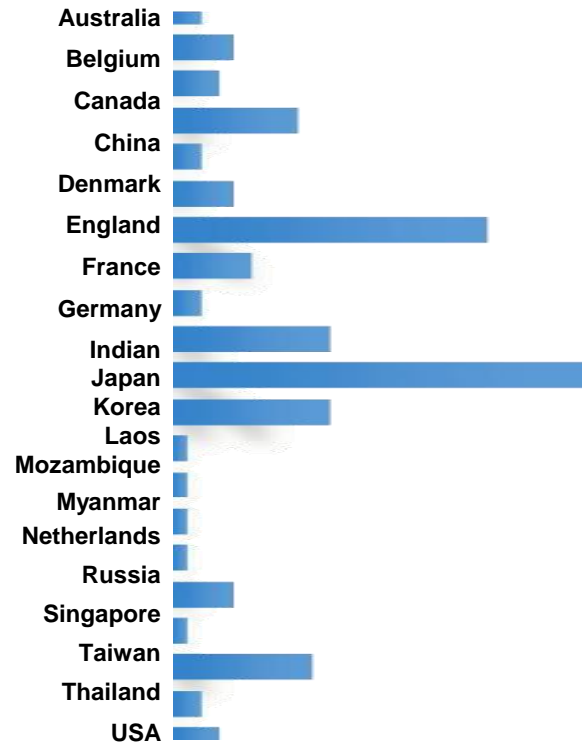



# 1. We are HUCE

## There are 14 Faculties & 13 Laboratories:

- 22 programs for Undergraduate
- 14 programs for Master
- 18 programs for Doctor
- Short-term training course with certificates

## There are 5 Undergraduate programs given in English:

1. Building & Industrial Engineering
2. Bridge & Road Engineering
3. Environmental Engineering
4. Architecture and Planning
5. Construction Economics and Management



ĐẠI HỌC XÂY DỰNG





1. We are HUCE

2. Exchange programs

3. Workshops and  
Activities

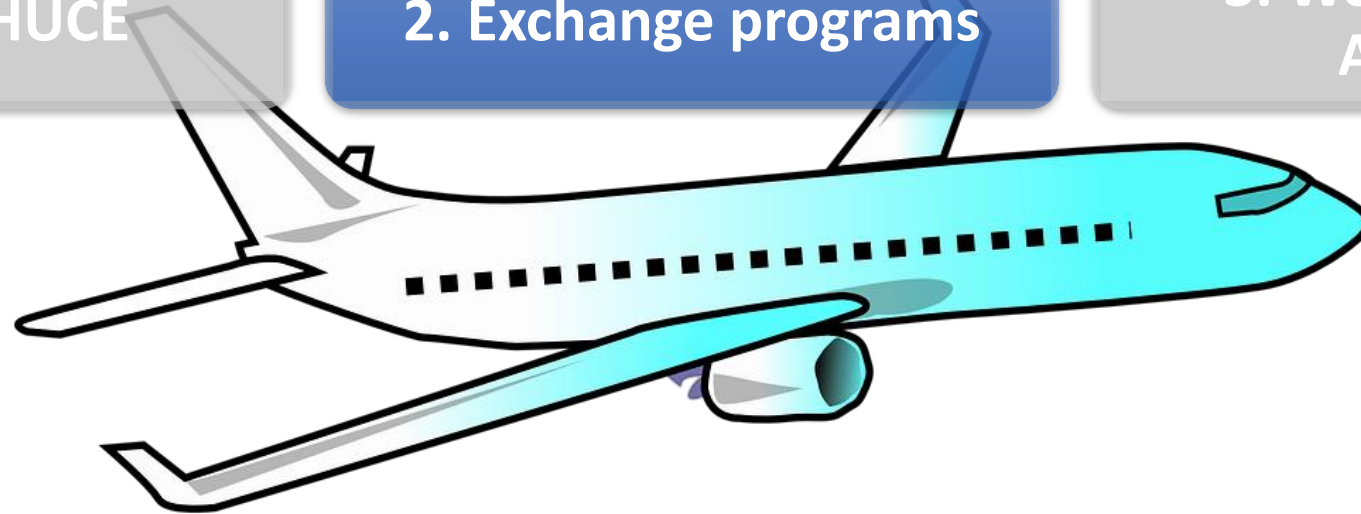

## 2. Exchange programs

### International Short - Term Courses

- Summer School
- Internship Course
- Student Exchange Program
- International Short - Term Courses



## 2. Exchange programs

### International Short - Term Courses

- Exchange student need to be a enrolled as a full time students undertaking research or taking courses at the host institution.
  - Have completed at least one year full time at home institution
  - Meet all admission and specific requirements of the home and host institution
- Duration of exchange program: one semester – one academic year
- Each program may receive 5-10 students per semester (the scholarship is subject to change every year)



1. We are HUCE

2. Exchange programs

3. Workshops and  
Activities





# 3. Workshops and Activities

- Credit Courses following C.D.I.O philosophy



# 3. Workshops and Activities

- Workshops - Activities







## 3. Workshops and Activities

- Workshops - Activities





**TRƯỜNG ĐẠI HỌC XÂY DỰNG HÀ NỘI**  
**HANOI UNIVERSITY OF CIVIL ENGINEERING (HUCE)**



**THANK YOU FOR YOUR ATTENTION**

[www.nuce.edu.vn](http://www.nuce.edu.vn)



Bauhaus-  
Universität  
Weimar

德國·威瑪·包浩斯大學 系級交換計畫  
2020 / 21 Winter Semester Exchange



陳佳宏

Chen, Chia Hung

B 0 5

#### International Exchange Experience

2018 TSA in Taiwan

2019 TSA in Tokyo

2020 Weimar Bauhuas Exchange

An aerial photograph of a town covered in snow during a winter sunrise. The sun is a bright, glowing orb in the upper left sky, casting a warm, golden light over the scene. The town's buildings, with their snow-laden roofs and some visible chimneys emitting wisps of smoke, are densely packed. The foreground shows a snow-covered parking lot with several cars. The overall atmosphere is serene and quiet.

# Motivation

# About Weimar

---

人口只有六萬的美麗小鎮

世界文化遺產 威瑪共和國的首都

德國中部的圖林根邦(Thüringen) 物價便宜、交通方便

納粹所興建的布痕瓦德集中營(Buchenwald)

大文豪歌德、哲學家尼采



## About Bauhaus

---

沃爾特·格羅佩斯 (Walter Gropius) 以工藝藝術學校的形式創立。

少即是多 (Less is more)、極簡主義 (Minimalism)、  
功能主義 (Form follows function)

幾何圖式抽象畫家康丁斯基 (Wassily Kandinsky)

碩士課程部分是英文授課；跨學院授課；豐富的 Project、語言、體育課。

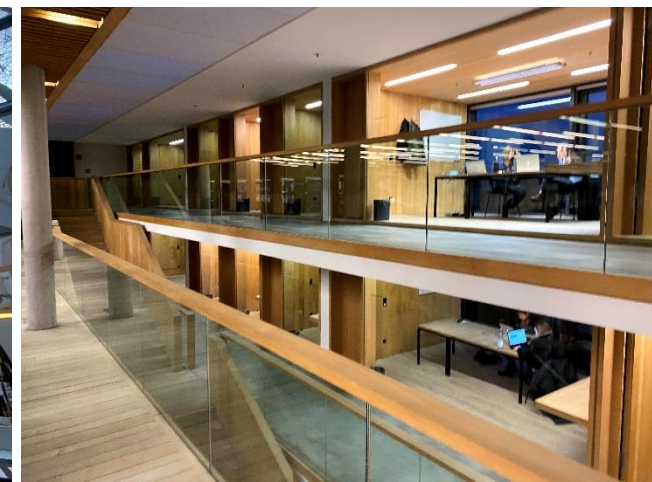

Design by Research – Evidence Based Design Strategies for User-Centred Buildings : 12 Credits

Computational Methods for User-Centered Architectural Design : 3 Credits

Parametric Building Information Modeling : 3 Credits

Urban Sociology (Introduction) : 3 Credits

Valuation Real Estate : 3 Credits

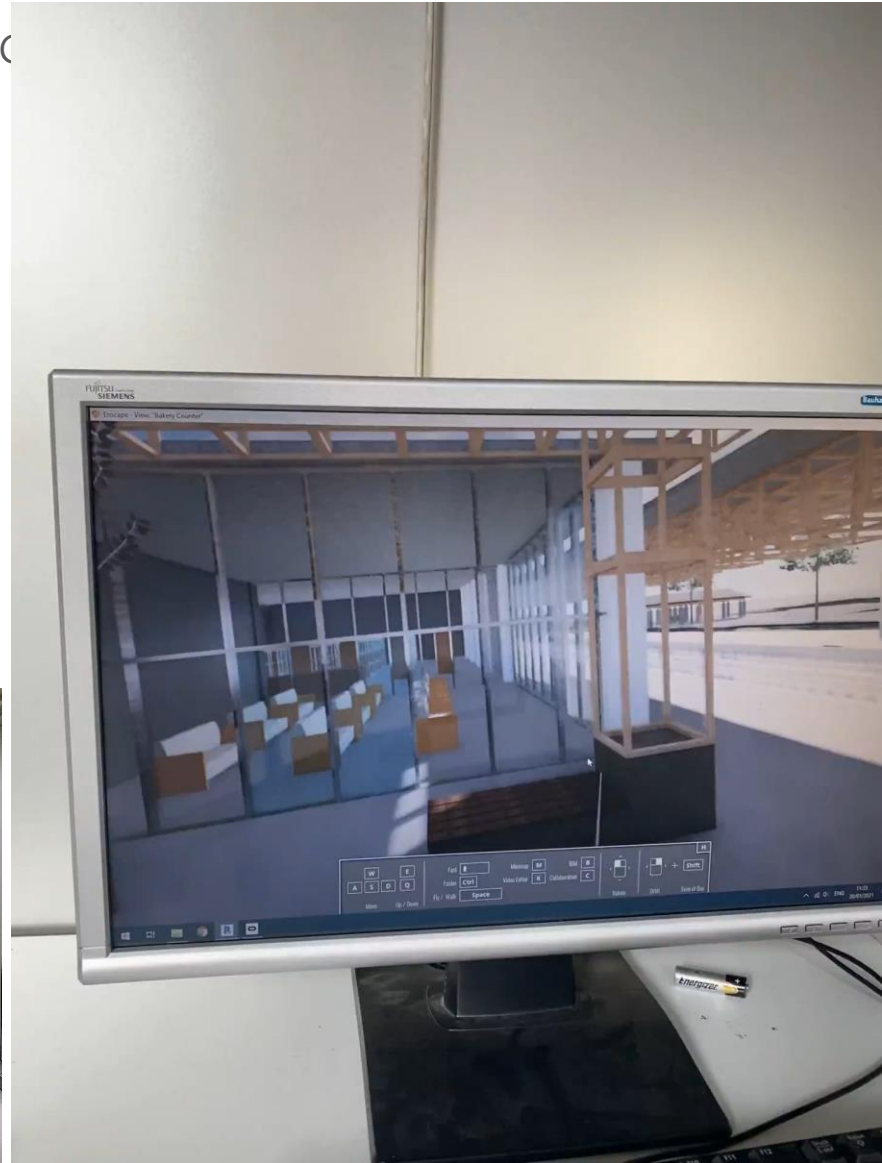
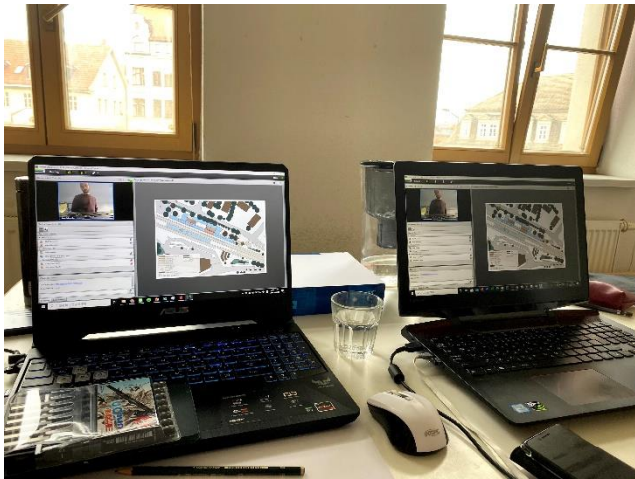



# DESIGN BY RESEARCH

## Train Station Buxtehude

Motofumi Tsuda

Chen Chia-Hung

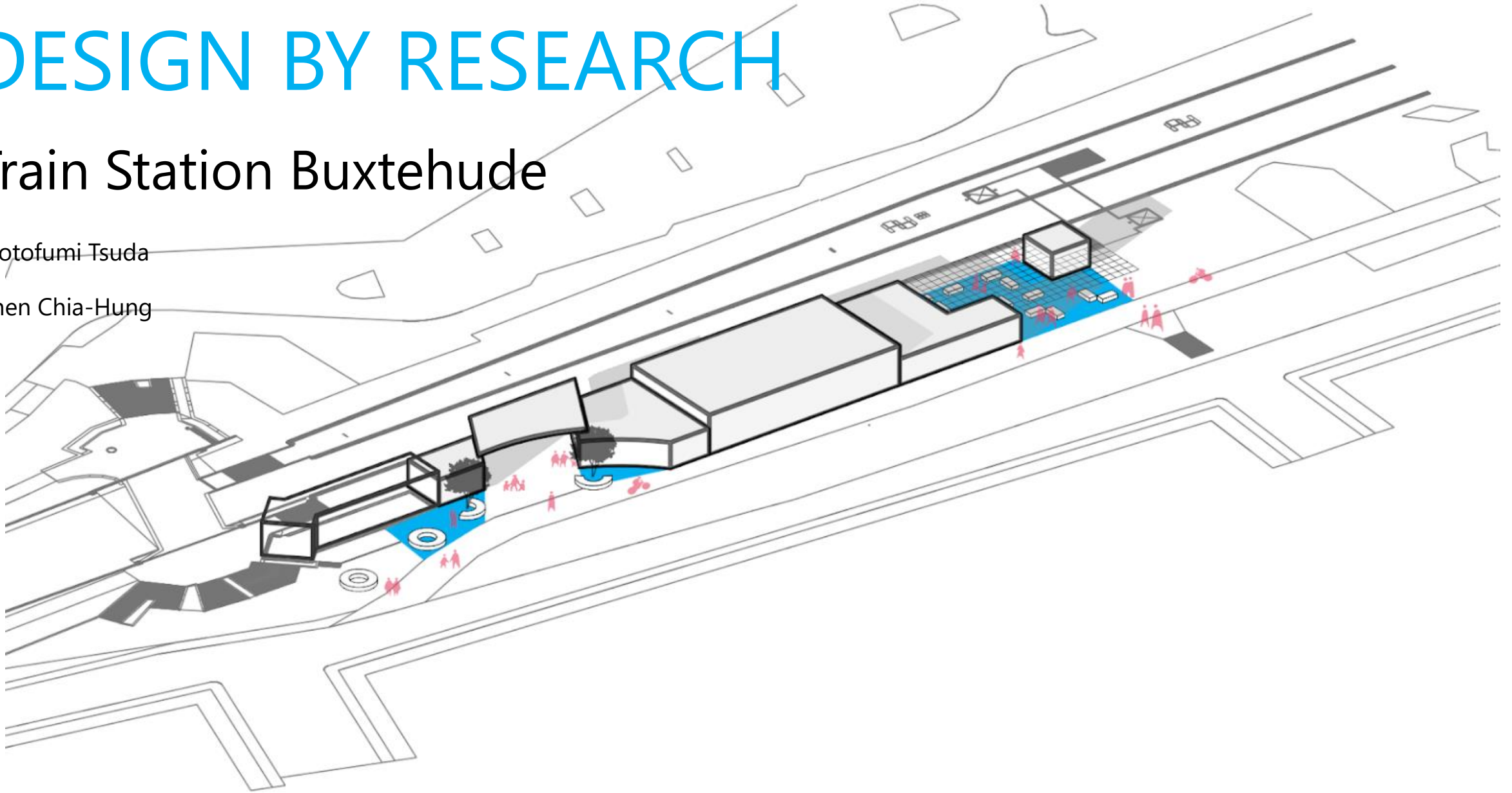

# DESIGN CONCEPT

## #1 Site Analysis

The existing station is far away from the main street. We propose a station with a main entrance to Bahnhofstraße to open up the train station to the city centre.

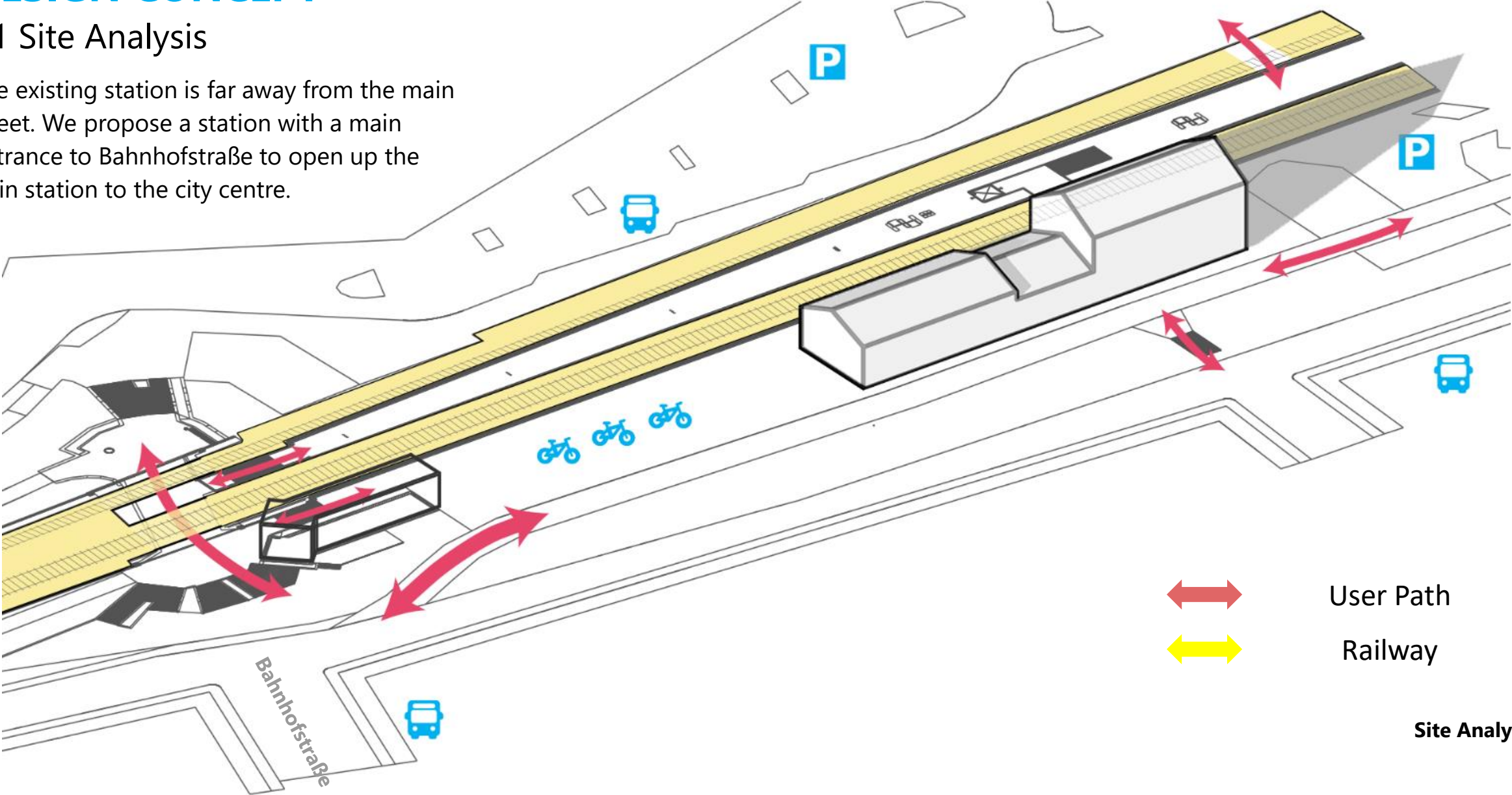

↔ User Path  
↔ Railway

Site Analysis

# DESIGN CONCEPT

## #2 Volume cut base on path

The main entrance will be created from Bahnhofstraße. A secondary entrance will connect the bicycle and car parking with the train station.

The services at the train station are ordered to create an easy access for travellers and visitors.

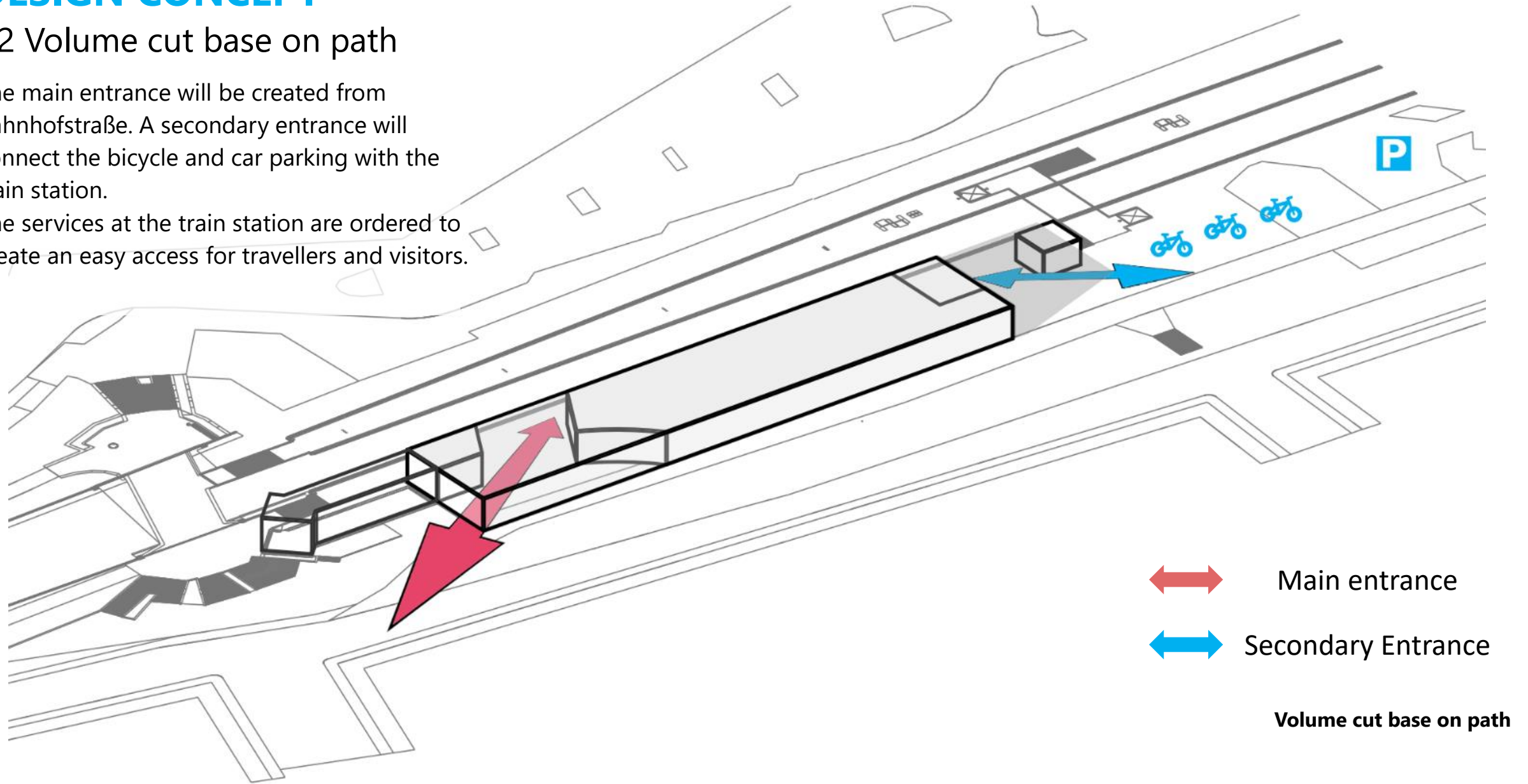

↔ Main entrance

↔ Secondary Entrance

Volume cut base on path

# DESIGN CONCEPT

## #3 Different Height

The topography of the train station is irregularly to create an interesting architectural design. Furthermore it should guide people around the train station.

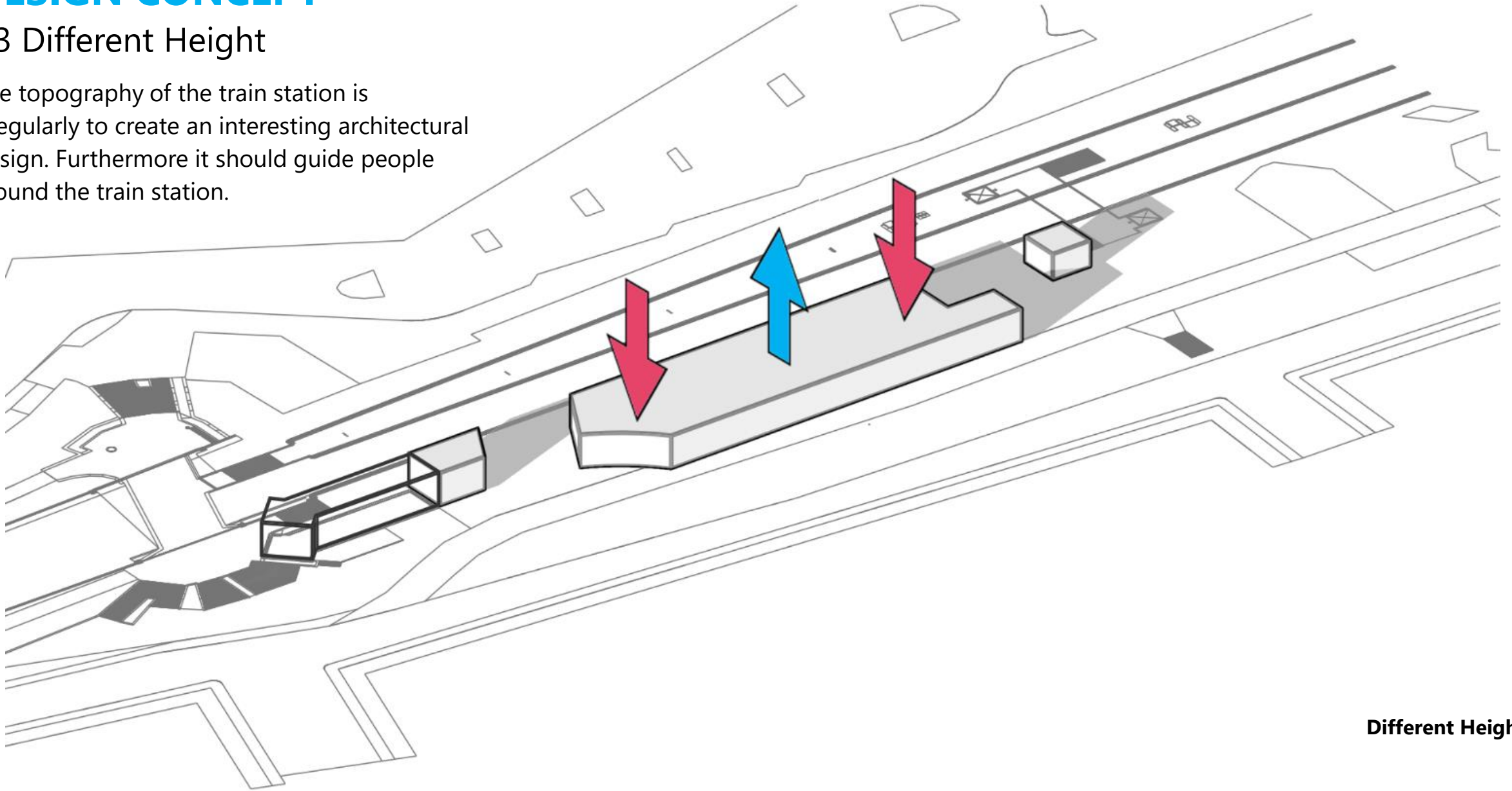

**Different Height**

# DESIGN CONCEPT

## #4 Attractive User

The highest roof at the main entrance can also provide train station higher visibility form the main street.

Beside, two existing trees in front of the main entrance becomes the gate of reception hall.

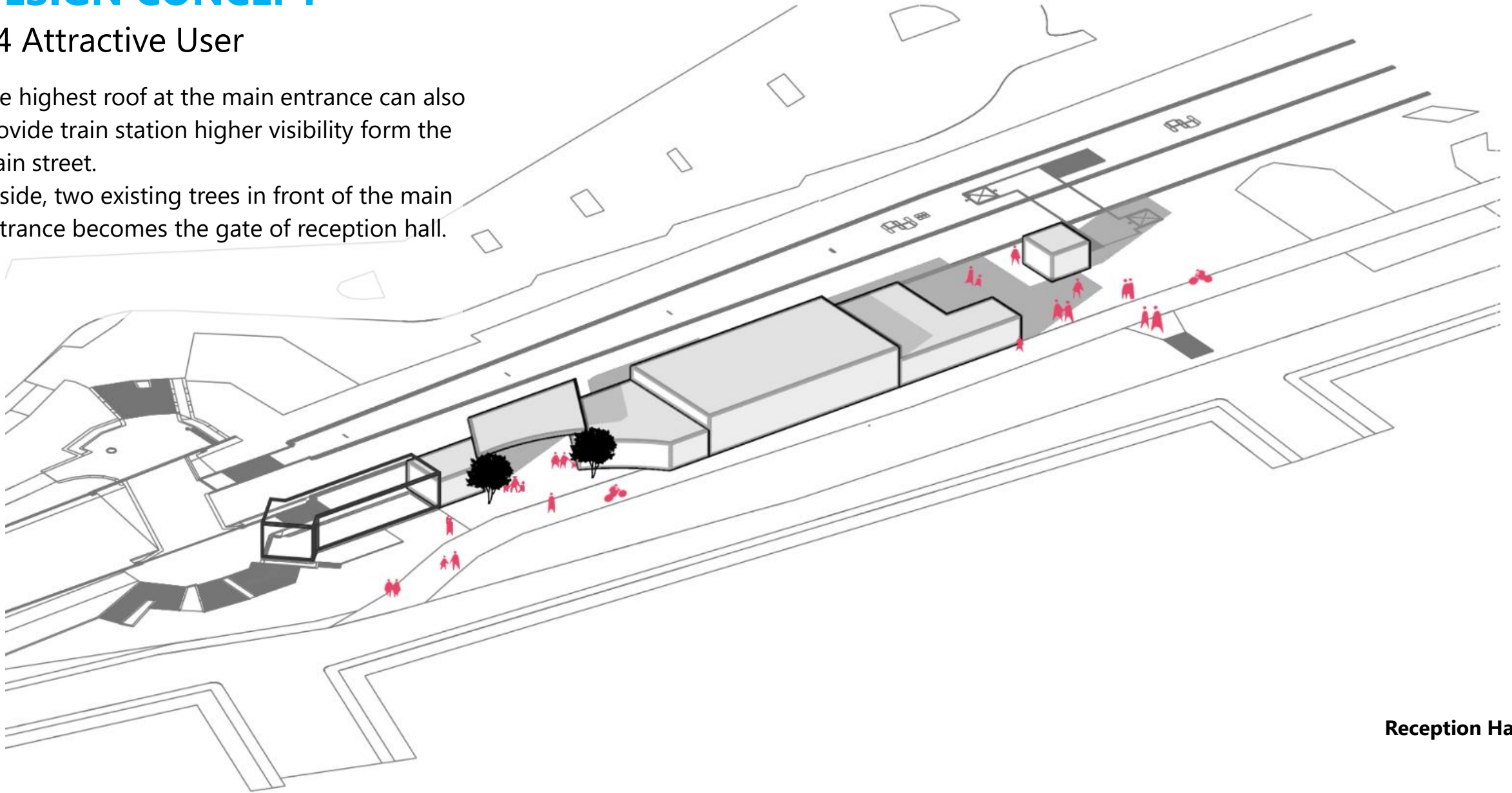

Reception Hall

# #1-1 COMPREHENSIBILITY

## Result 1: Space Experience of Entrance

Based on our assumption, the different height of roof imply users to know there is different functional space under it.

According to the assumption result, the Variant B get higher scores in comprehensive, simple and remarkable aspects. It means that Variant B has the higher Comprehensibility.



**Variant A**

(Ramp Roof)

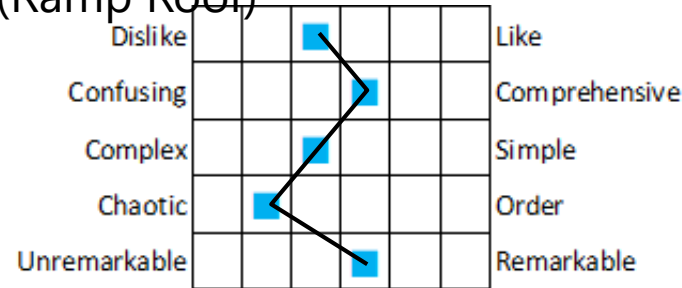

**Variant B**

(Stepped Roof)

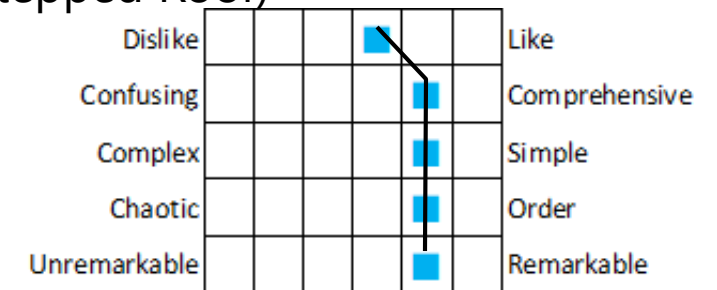

**Result of Semantic Differential**

# #1-1 COMPREHENSIBILITY

## Result 2: Wayfinding Task

Based on our assumption, we thought that the Stepped Roof would play the important role of orientation and user could reach the DB service store more easily than the Ramp roof.

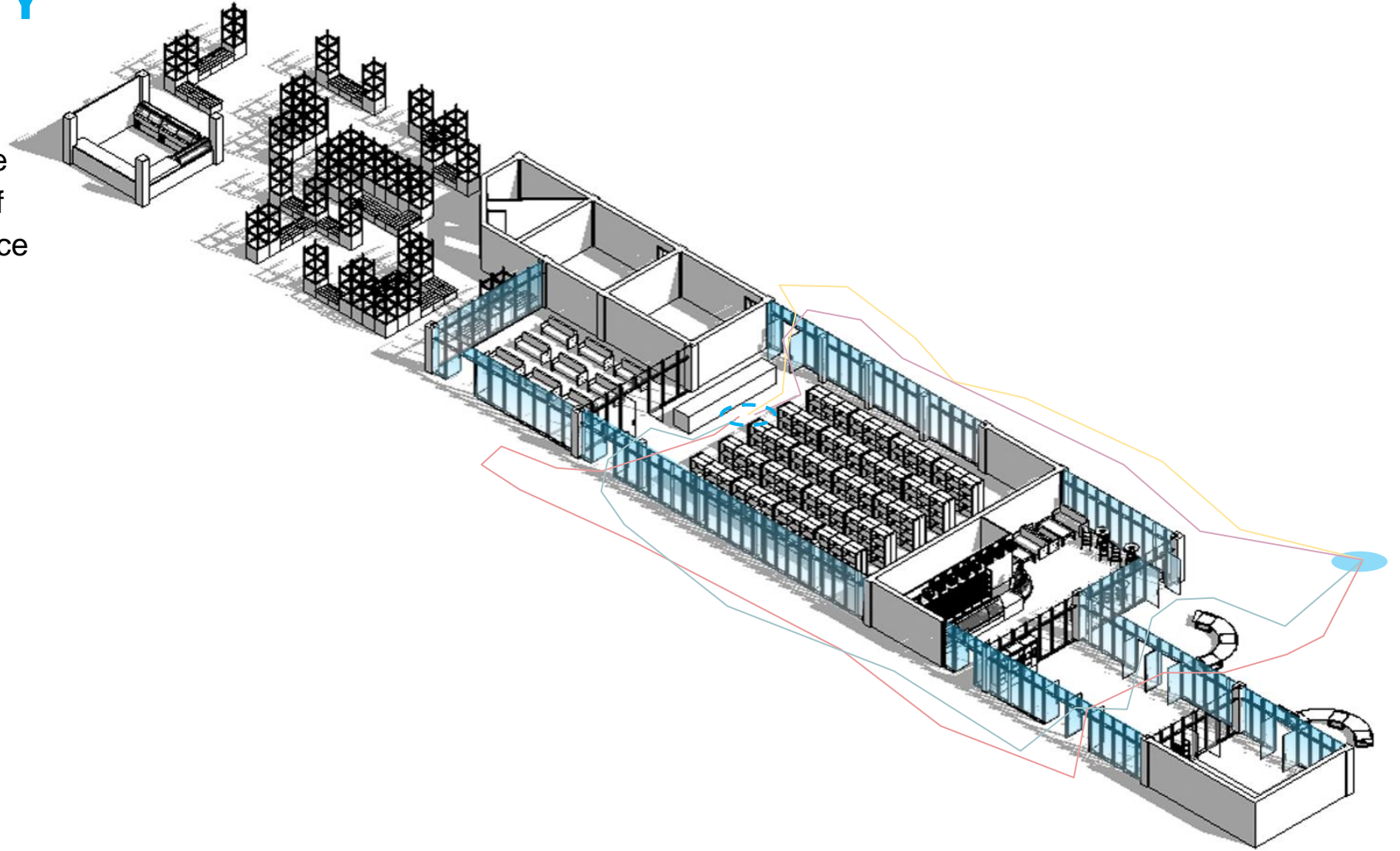

Mapping of User Group B's Wayfinding Route

## #2-2 SEAT PREFERENCE

How does **brightness, accessibility and visibility** affect users seat preference?

The interior seats in Bakery is important for customers. That's why the bakery must provide cozy space for users.

The goal of the study is to figure out the relation between user's seat choice and daylight analysis result. Then, We will make high quality seat base on the result of analysis.



**Participant A**  
Conner seat



**Participant B**  
Window seat



**Participant C**  
Sofa seat

**The Different Types and Location of Seats in Bakery**



## #2-2 SEAT PREFERENCE

### Result: Visibility Analysis

Based on our assumption, we believe that the seat with lower visibility will attract more user to choose for the feeling of private. But in the same time, we also believe the factor of daylight will have more influence of the result.

According to the result of visibility analysis, it's doesn't fit. Because our previous result, the more user will choose the seat with higher illuminance.

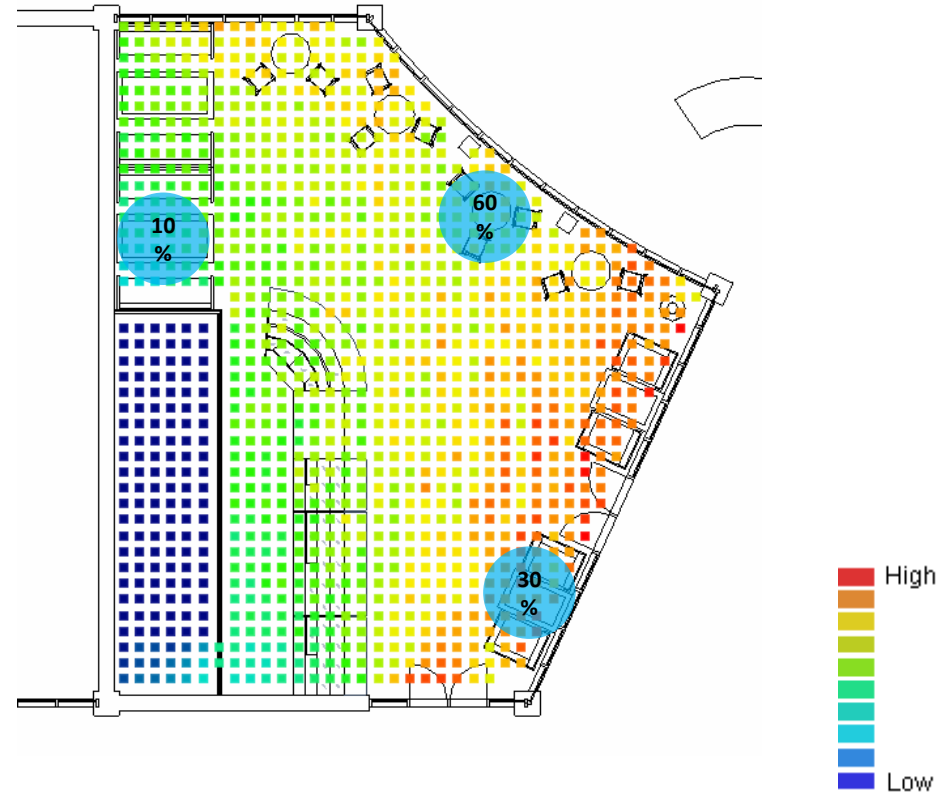

Visibility Analysis

## #3-1 ACCESSIBILITY and VISIBILITY

Method: Studying based on 3D isovist

Set up the Ticket Machine where is easy to find for users who come from secondary entrance.

Place multiple boxes and use 3D isovist to find out how many isovist rays hit the objects. Then set up the Ticket Machine in the place where got high score.

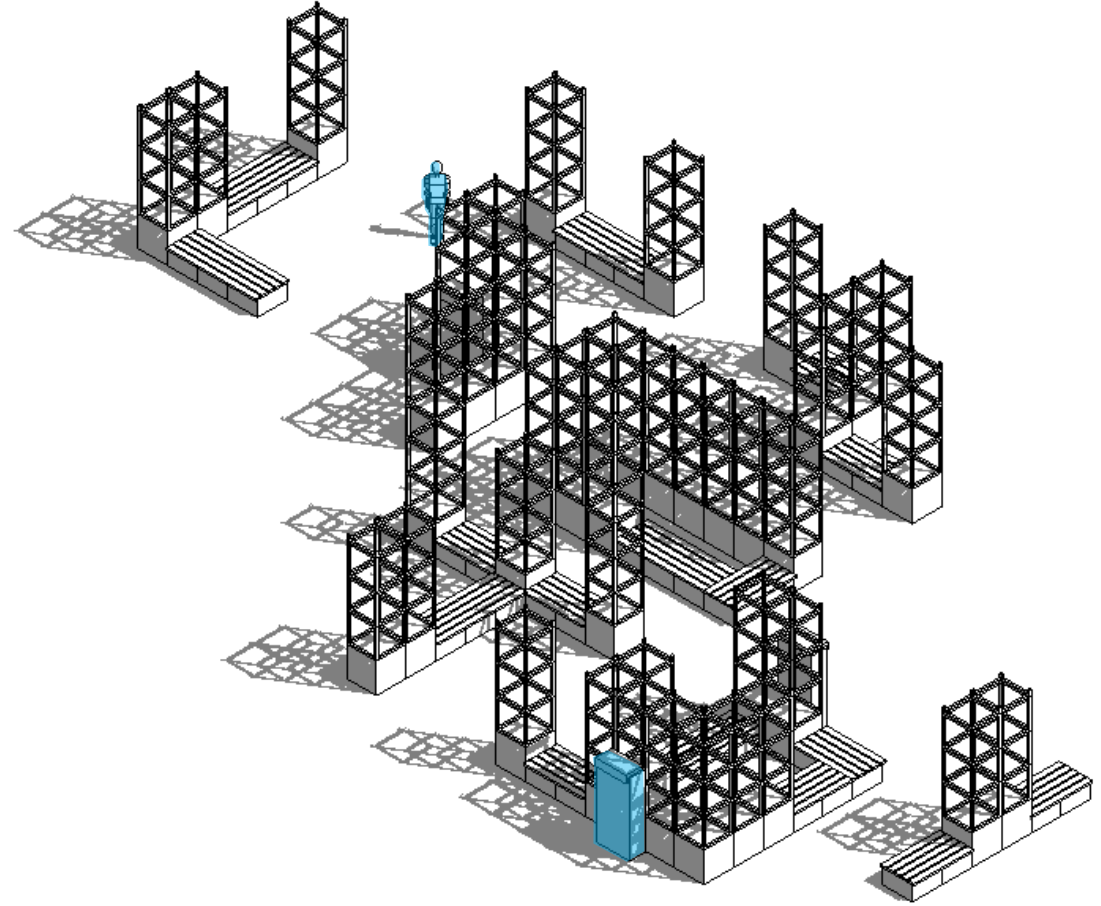

# #3-1 ACCESSIBILITY and VISIBILITY

Result: : Studying based on 3D isovist

According our result, we can find out that the ticket machine located near platform has higher number of Isovist rays hit count. And it makes sense because there is fewer obstacle for user.

Therefore, we will choose Location B and C to set up our ticket machine based on the result of 3D Isovist.

	Dwayne	Alex	Jay	average
A	1.5	0.4	0	0.63
B	1	1.8	0.7	1.17
C	0	1.2	3.6	1.60
D	0.1	0	0.8	0.30
E	0.6	1.2	0.8	0.87

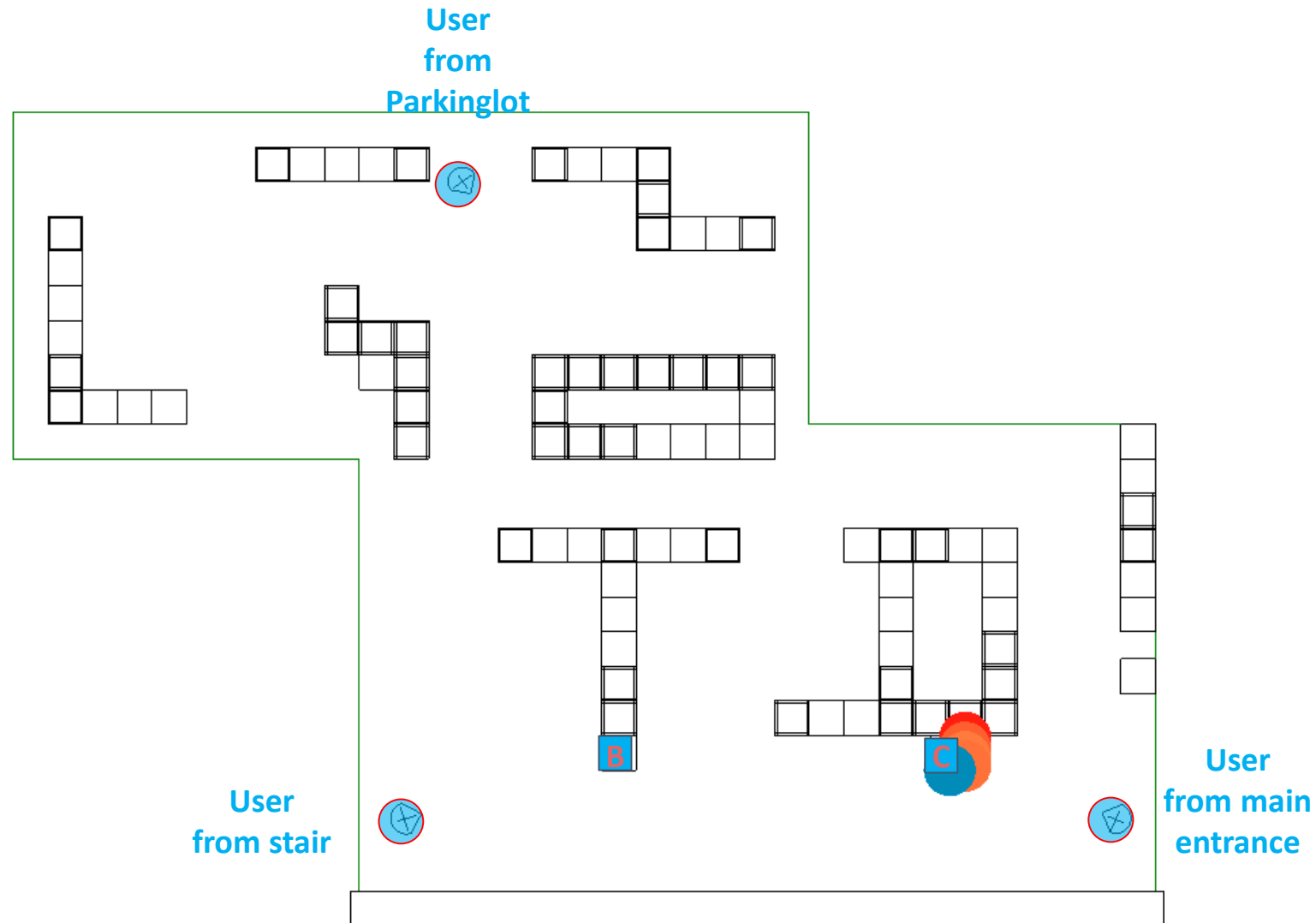

# 課外活動

Life During Lock down

---

Erasmus

Party

Food

Travel

Hiking





Break out of the comfort zone



CE YEAR 3 HUNG HO TIN

# City University of Hong Kong

Joint Bachelor's Degree Programme  
between CityU and NTU

# For CityU Students

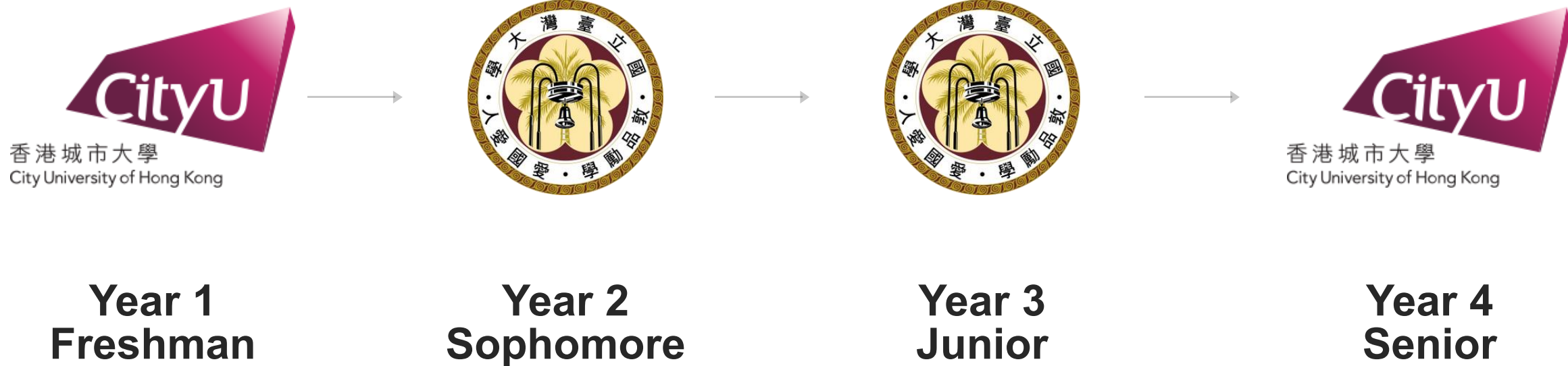

**CityU and NTU graduation  
certificates**





# For NTU Students



香港城市大學  
City University of Hong Kong



香港城市大學  
City University of Hong Kong



**Year 1  
Freshman**

**Year 2  
Sophomore**

**Year 3  
Junior**

**Year 4  
Senior**

**CityU and NTU graduation  
certificates**



# Course mapping

Year 2 at CityU (42/3942 <sup>#</sup> credits)	[Criteria B] Liberal Education (A2)	3	[GE] GE1501 Chinese Civilisation - History and Philosophy <sup>Note 4</sup> [CAH Department requests NTU students to take GE1501 at CityU to receive CityU degree]	3
	[Criteria B] Liberal Education (A1)	3	[GE] GE2410 English for Engineering <sup>Note 4</sup> [EN Department requests NTU students to take GE2410 at CityU to receive CityU degree]	3
	[Criteria B] Liberal Education (A5)	3	[GE] Gateway Education (Area 2)	3
	[Criteria B] Liberal Education (A8)	3	[GE] Gateway Education (Area 3)	3
	[Criteria F] 501 38080 Engineering and Law 工程與法律	3	[GE] CA2066 Professionals and Society [For students admitted to NTU in 2020 and thereafter.] [Major-Core] CA1166 Professionals and Society <sup>#</sup> [Only for students admitted to NTU in 2019, counted as an elective outside the programme.]	3 3 <sup>#</sup>
	[Criteria G] 521 U9090 Introduction to Environmental Engineering and Science 環境工程與科學	3	[Major-Core] CA2169 Environmental Engineering	3
	[Criteria F] 501 39960 Engineering Geology and Its Applications 工程地質與應用	3	[Major-Core] CA2560 Geology for Engineers	3
	[Criteria D] 501 27900 Engineering Material 工程材料學	2	[Major-Core] CA2674 Construction Materials <sup>Note 5</sup>	3
	[Criteria D] 501 23000 Fluid Mechanics 流體力學	3	[Major-Core] CA2675 Fluid Mechanics	3
	[Criteria E] 501 25010 Transportation Engineering 運輸工程	3	[Major-Core] CA2676 Transportation Engineering	3
			[Major-Core] CA3168 Building Information Modelling for Capital Projects	3
	[Criteria F] 501 40200 Design of Steel Structure 鋼結構設計	3	[Major-Core] CA3619 Design of Structural Elements	3
	[Criteria D] 501 35700 Engineering Economics 工程經濟	2	[Major-Elective] CA3401 Construction Management and Economics <sup>Note 5</sup>	3
	[Criteria H] Free-elective course 自由選修	3	[Major-Elective] CA2505 Industrial Training - Civil Engineering [NTU students are required to do their Industrial Training during the summer term they stay with CityU.]	3
Year 3 at CityU (42 credits)	[Criteria D] 501 21210 Mechanics of Materials 材料力學	4	[Major-Core] CA3632 Mechanics of Structures and Materials <sup>Note 6</sup>	3
	[Criteria E] 501 32410 Structural Theory (I) 結構學一	3	[Major-Core] CA3633 Structural Analysis	3
	[Criteria D] 501 32320 Reinforced Concrete 鋼筋混凝土學	3	[Major-Core] CA3634 Reinforced and Prestressed Concrete Structures	3
	[Criteria D] 501 32900 Hydrology 水文學	3	[Major-Core] CA3677 Hydraulics and Hydrology	3
	[Criteria E] 501 37800 Construction Management 營建管理	3	[Major-Core] CA3686 Construction Contract and Management	3
	[Criteria D] 501 36000 Soil Mechanics 土壤力學	3	[Major-Core] CA3687 Soil Mechanics	3
	[Criteria G] 501 32240 Structural Systems for Civil Engineering 土木結構系統	3	[Major-Core] CA3704 Construction Engineering	3
	[Criteria H] Free-elective course 自由選修	3	[Major-Core] CA4708 Finite Element Methods in Civil Engineering	3
	[Criteria G] 501 49501 Bachelor Thesis 學士論文	4	[Major-Core] CA4516 Final Year Project <sup>Note 6</sup>	6
	[Criteria D] 501 34130 Civil Engineering Capstone Challenge 土木工程設計實務	3	[Major-Core] CA4526 Integrated Building Project Development (Civil Engineering)	3
	[Criteria H] Free-elective course 自由選修	3	[Major-Core] CA4665 Geotechnical Analysis and Design	3
	[Criteria E] 501 36210 Foundation Engineering 基礎工程	3	[Major-Core] CA4682 Advanced Geotechnical and Foundation Engineering	3
	[Criteria H] 541 M0210 Environmental Chemistry 環境化學	3	[Major-Elective] CA4679 Advanced Environmental Engineering	3
	Credits transferred from CityU	78	Credits earned at CityU	84/8184 <sup>#</sup>

# Academic calendar

## 16 weeks

<i>Provisional Academic Calendar 2022/23</i>		
	<u>Start Date</u>	<u>End Date</u>
<b>Semester A</b>		
Teaching Period	29 August 2022	26 November 2022
Student Revision Period	28 November 2022	3 December 2022
Examination Period	5 December 2022	17 December 2022
<i>Semester Break</i>	19 December 2022	7 January 2023
<b>Semester B</b>		
Teaching Period	9 January 2023	15 April 2023
Student Revision Period	17 April 2023	22 April 2023
Examination Period	24 April 2023	8 May 2023
<i>Semester Break</i>	9 May 2023	3 June 2023

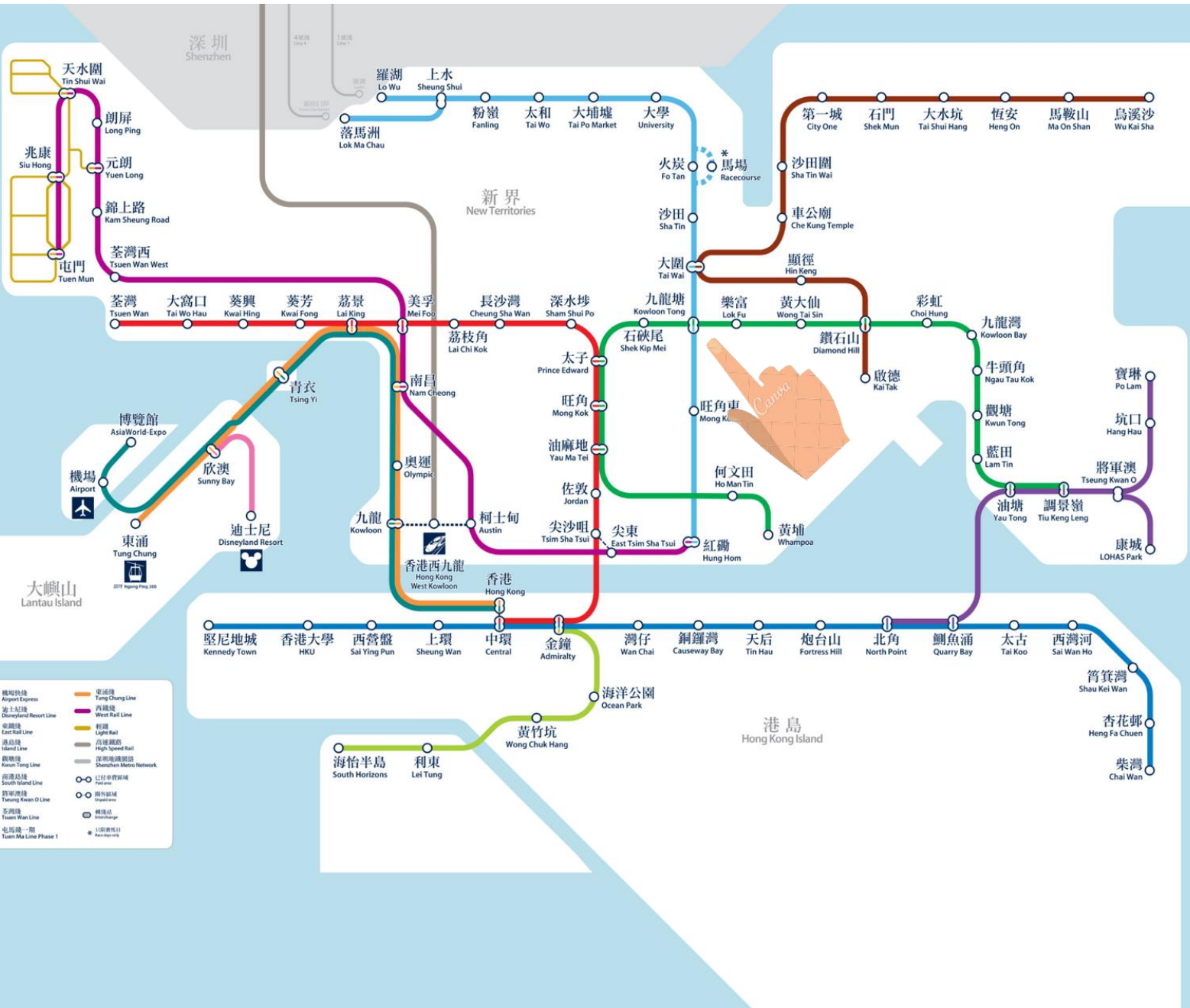

# Location

**-Center of HK**

**-Convenient**

# Hong Kong view



# Campus Life

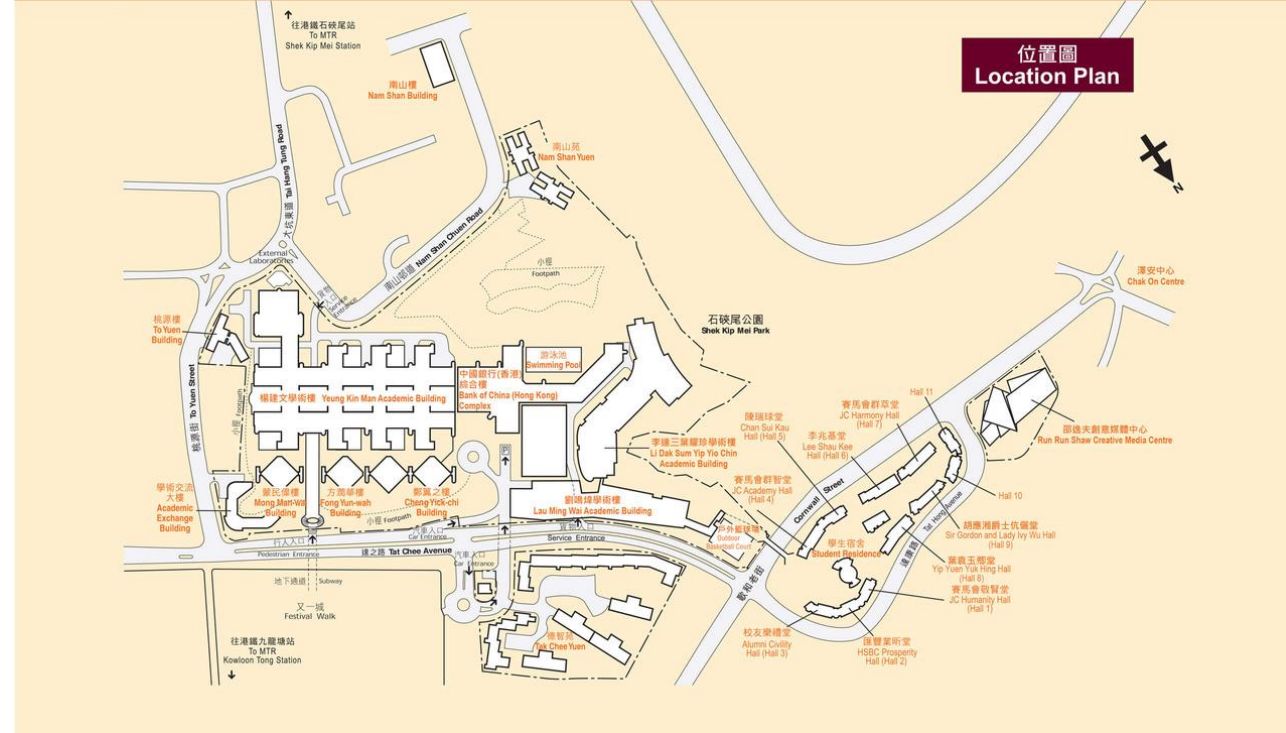

# Campus Life

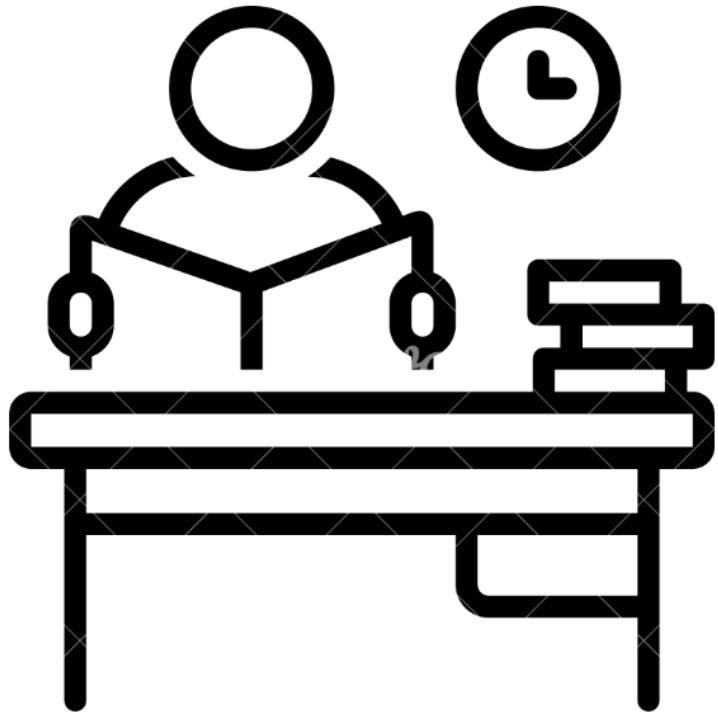

24-Hour

# Campus Life





# Campus Life

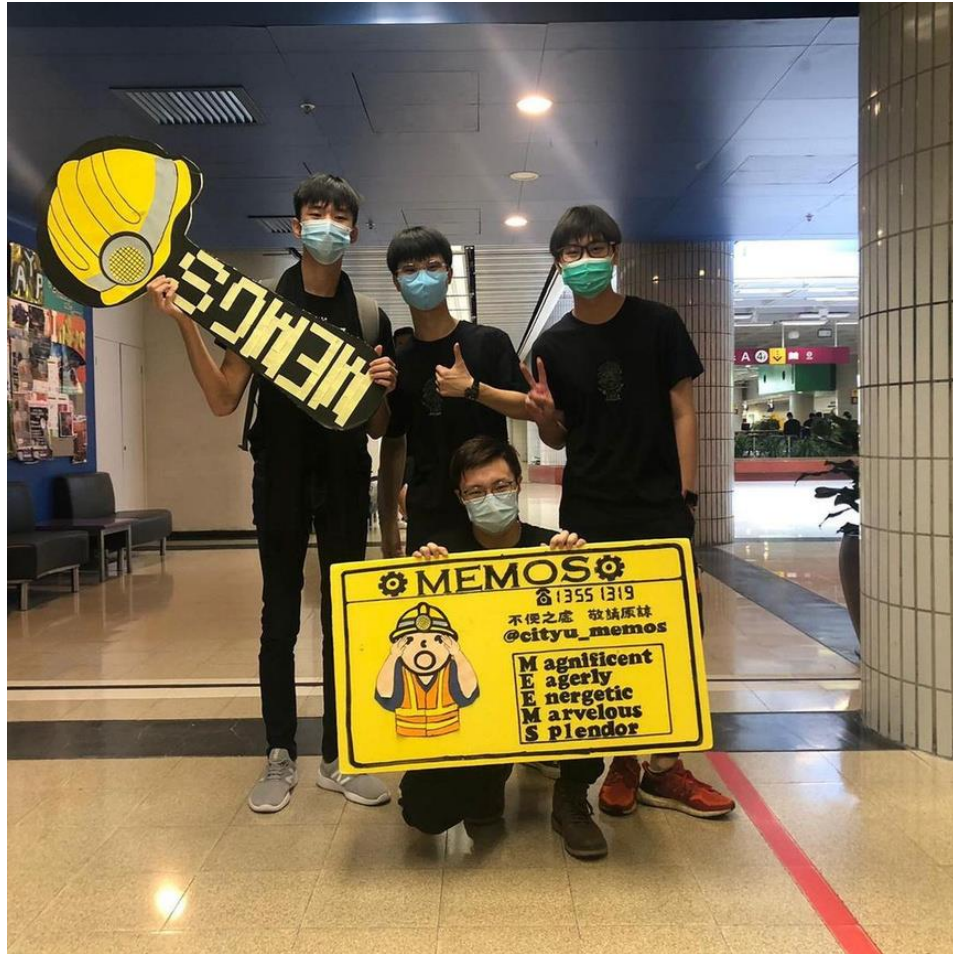

**NTU  
scholarship**

## **培璘-臺大人才培育計畫**

- **Interested in social issue**
- **Project based working**
- **Up to 700k NTD**

**Apply next year!!!**

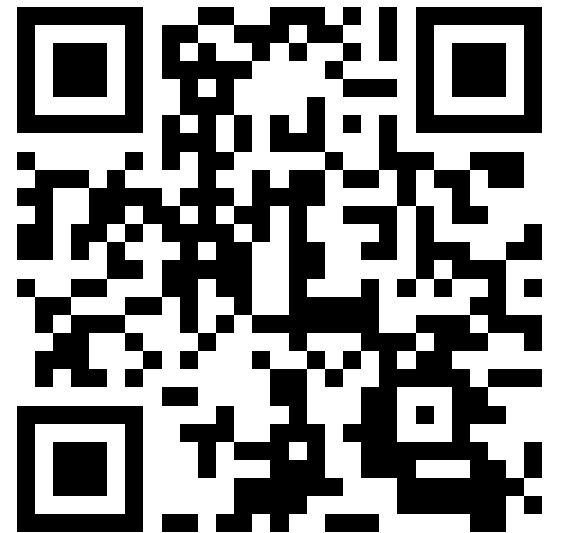

# **NTU scholarship**

- **Why you? (Specific/Creative)**
- **Why this project? (Important?)**
- **How to implement? (Practical)**

**Good luck !!!**

THANK  
YOU



**NTUCE  
2022/2023**

**NTU CE STUDY ABOARD  
INFORMATION SESSION**

**THANK YOU FOR LISTENING**

**23 November 2021**

**THE END**

IMPLEMENTED BY NTUCE